

Path: Z:\Projects\Sound to Olympics Trail Bainbridge\CAD Documents\Working\STO-SECTIONS.dwg
 Plot Date: 10/19/2016 8:42 AM
 Cad User: Arielle Fairina-Williams

| | | | | | | |
|----------------|-------------|----------|--------------|-------------------|-----------------------|-----------------|
| Drawn By: | Checked By: | Section: | Surveyed By: | Control Monument: | Recorded Survey: | Constructed By: |
| | | | | | Kitsap County Auditor | |
| XREF Filename: | | | | Field Bk/Pg: | AF- | Date: |
| | | | | | | |
| | | | | | Vol/Bk Page | |

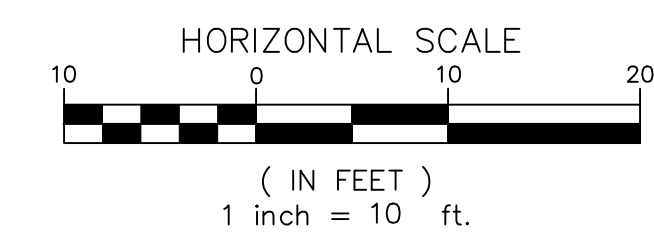
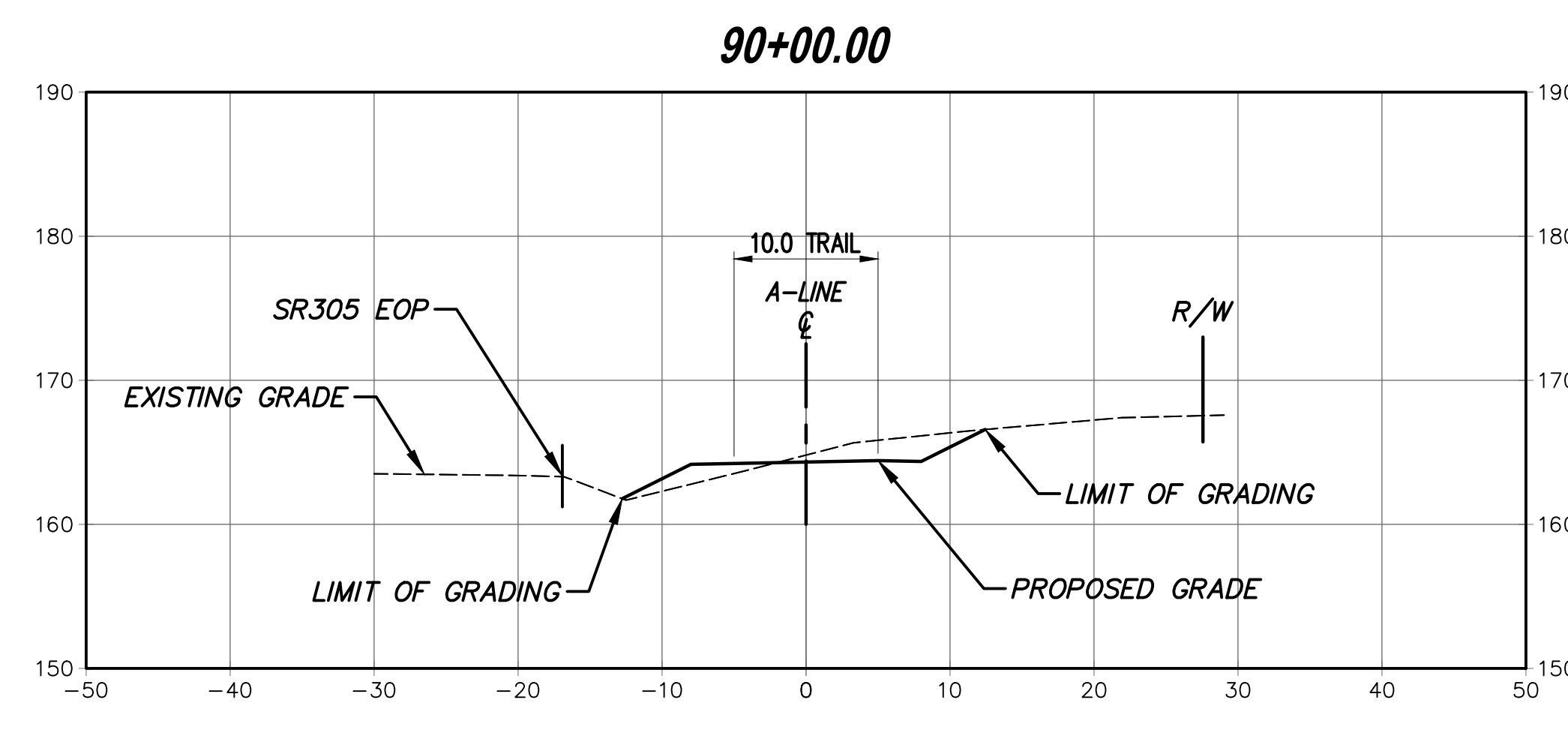
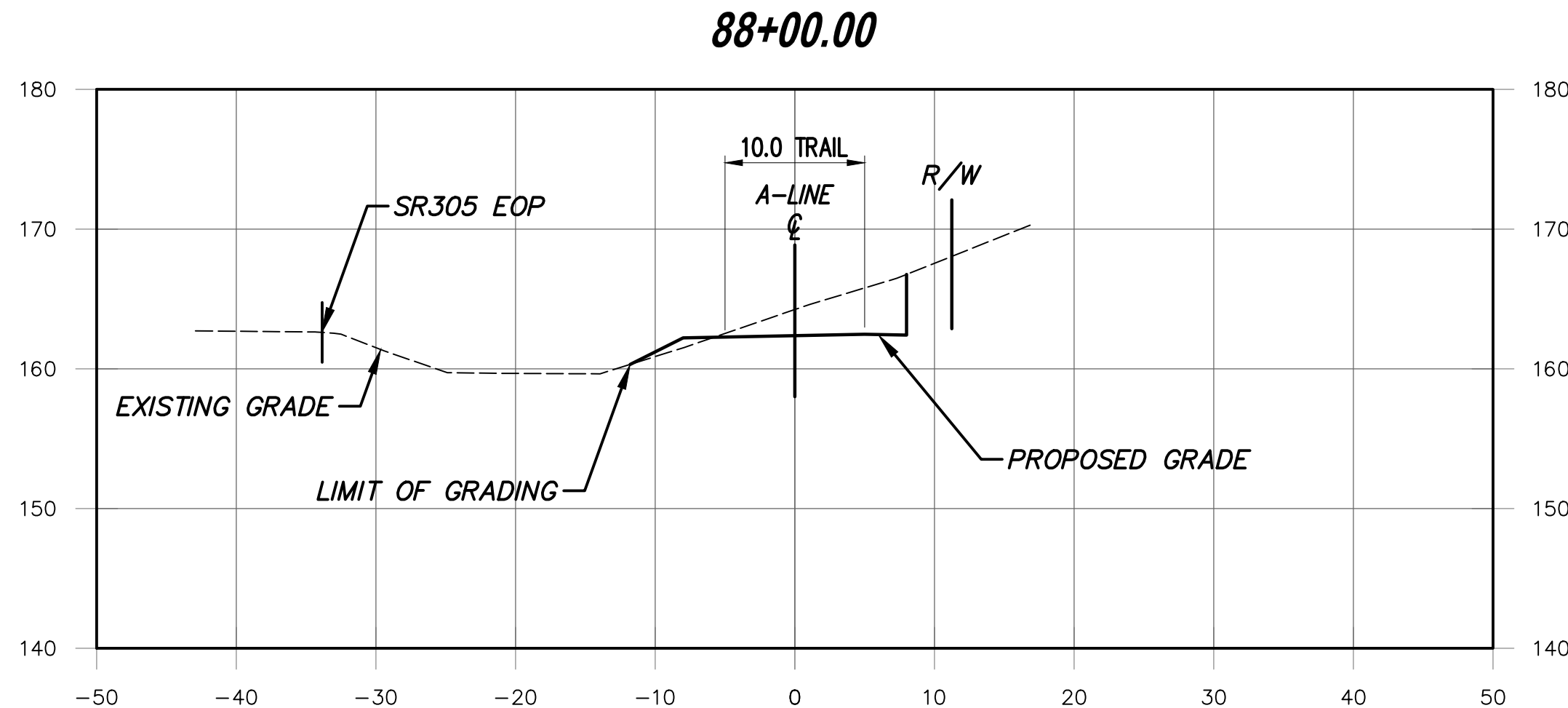
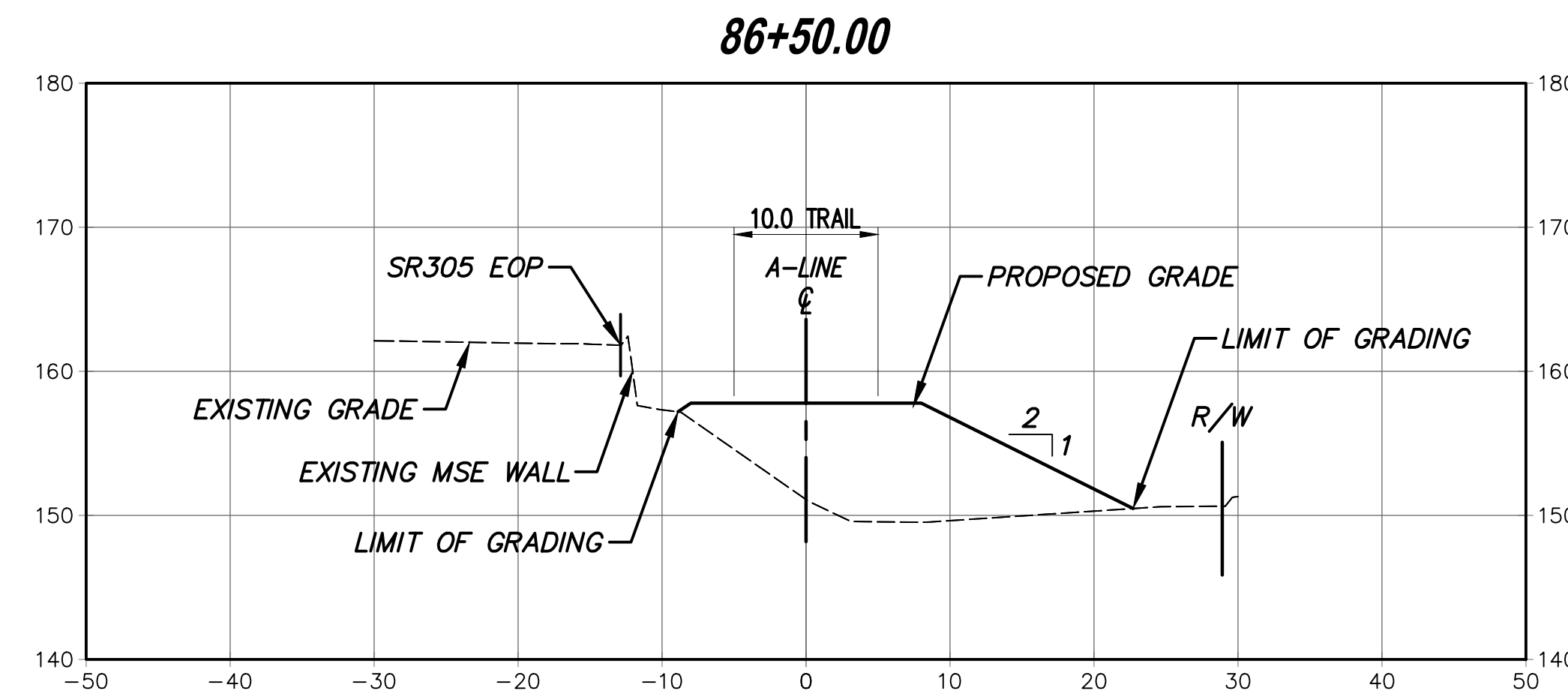
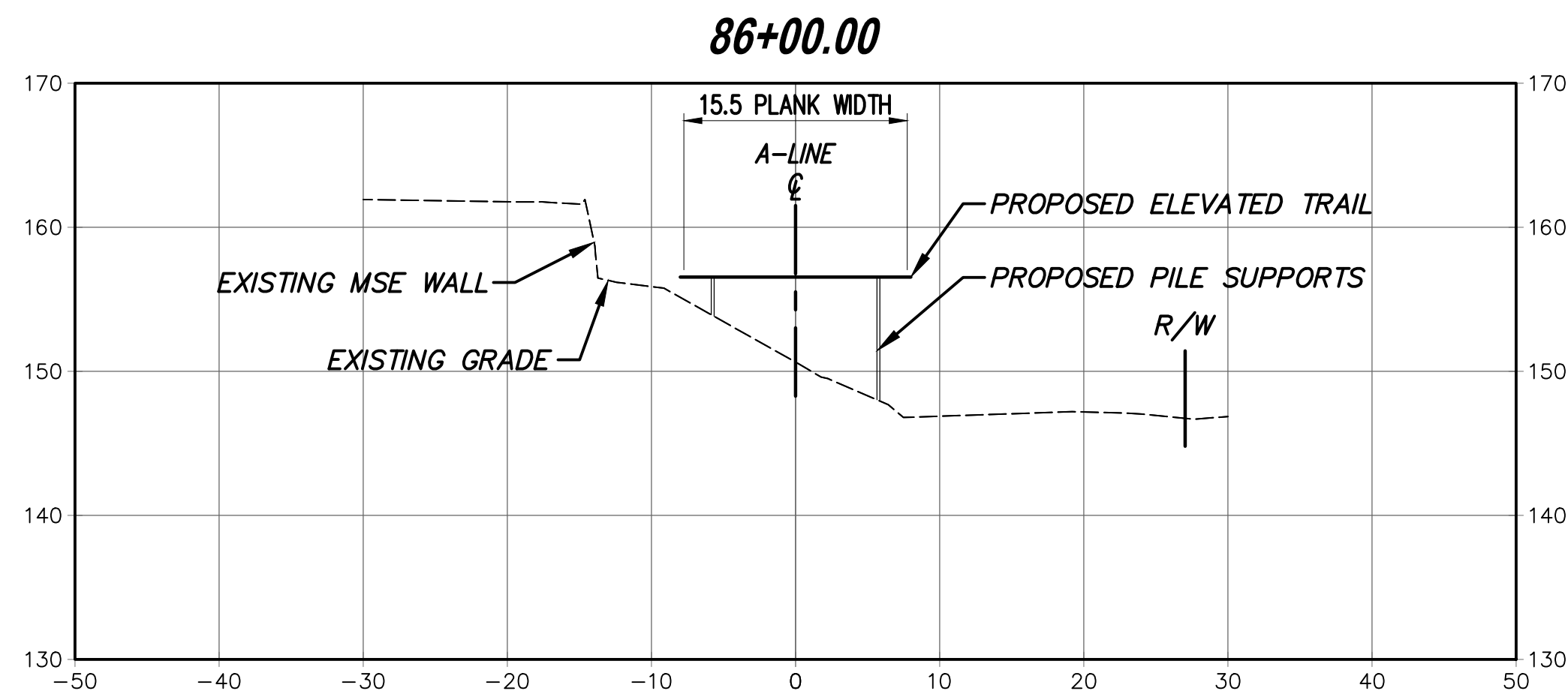

**PUBLIC WORKS
ENGINEERING
DEPARTMENT**

PROJECT INFORMATION

**SOUND TO OLYMPIC TRAIL
SR 305 CORRIDOR
ENHANCEMENTS
PHASE 2 & PHASE 4**

REVISION BLOCK

| NO. | DATE | BY | REVISION |
|-----|------|----|----------|
| | | | |
| | | | |
| | | | |
| | | | |
| | | | |
| | | | |
| | | | |
| | | | |
| | | | |
| | | | |

SEC. 26 , T. 25 N., R. 2 E., W. M.,
CITY OF BAINBRIDGE ISLAND, KITSAP COUNTY, WA.

Scale:
Horiz:
Vert:
Coordinate System:
Vertical Datum:
Designed By:
C RECKORD
Drawn By:
M STEWART
Inspected By:
W.O. No.:
Issue Date:

CROSS SECTIONS

**MacLeod
Reckord** PLLC
110 Prefontaine Place South, Suite 600
Seattle, Washington 98104
P 206-323-7919
F 206-323-9242

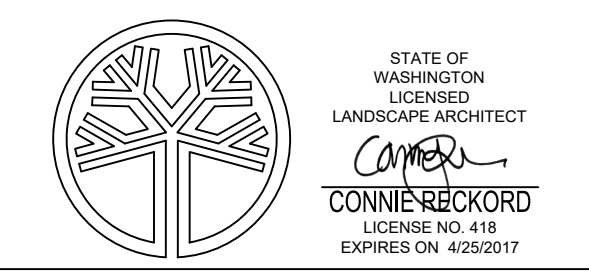

Drawing No. **C7.3**

Sheet No. **37** of **60**

| | | | |
|----------------|-------------------|-----------------------|-----------------|
| Section: | Control Monument: | Recorded Survey: | Constructed By: |
| Drawn By: | Field Bk./Pg.: | Kitsap County Auditor | Date: |
| Checked By: | | AF- | |
| XREF Filename: | | Vol/Bk. Page: | |

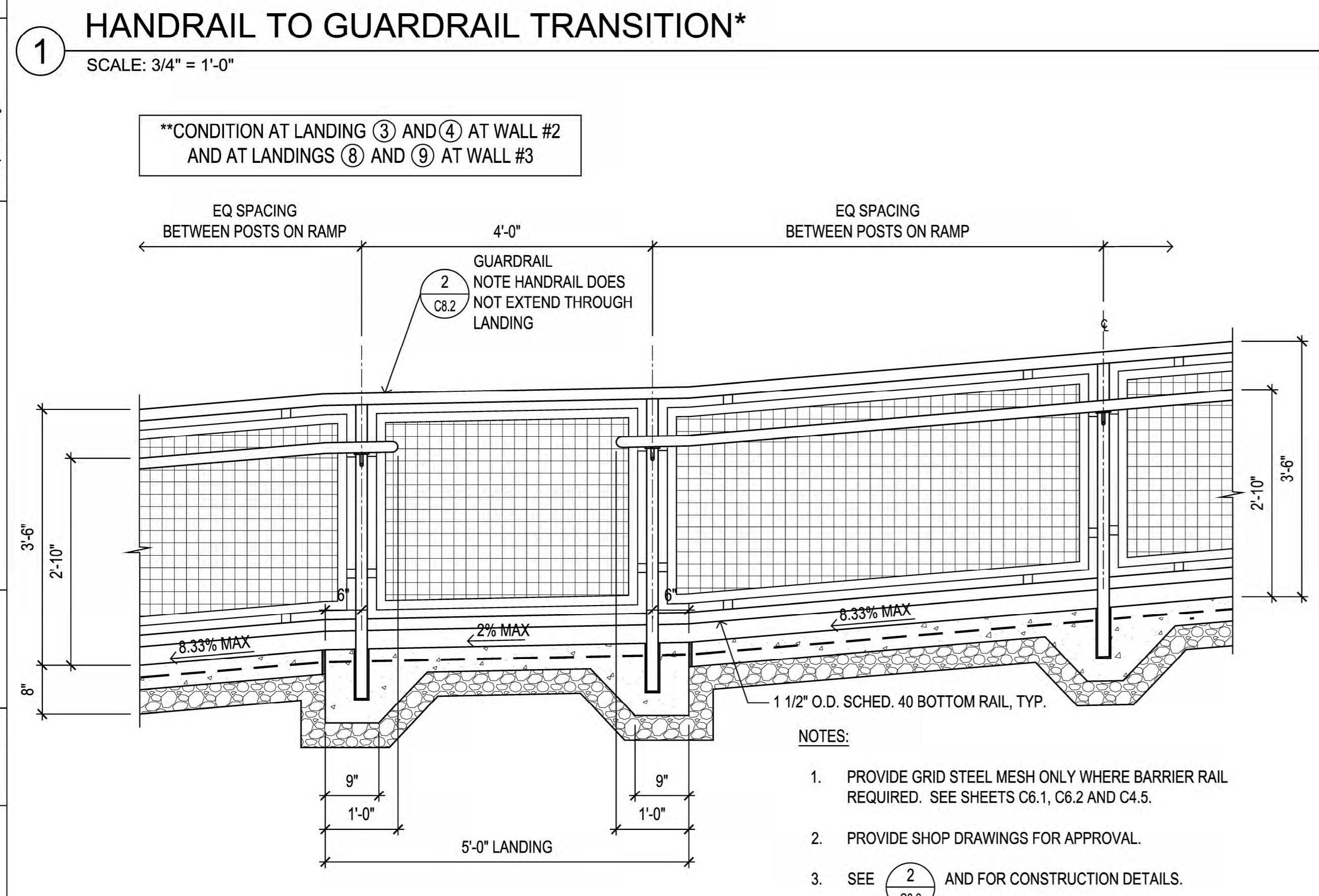
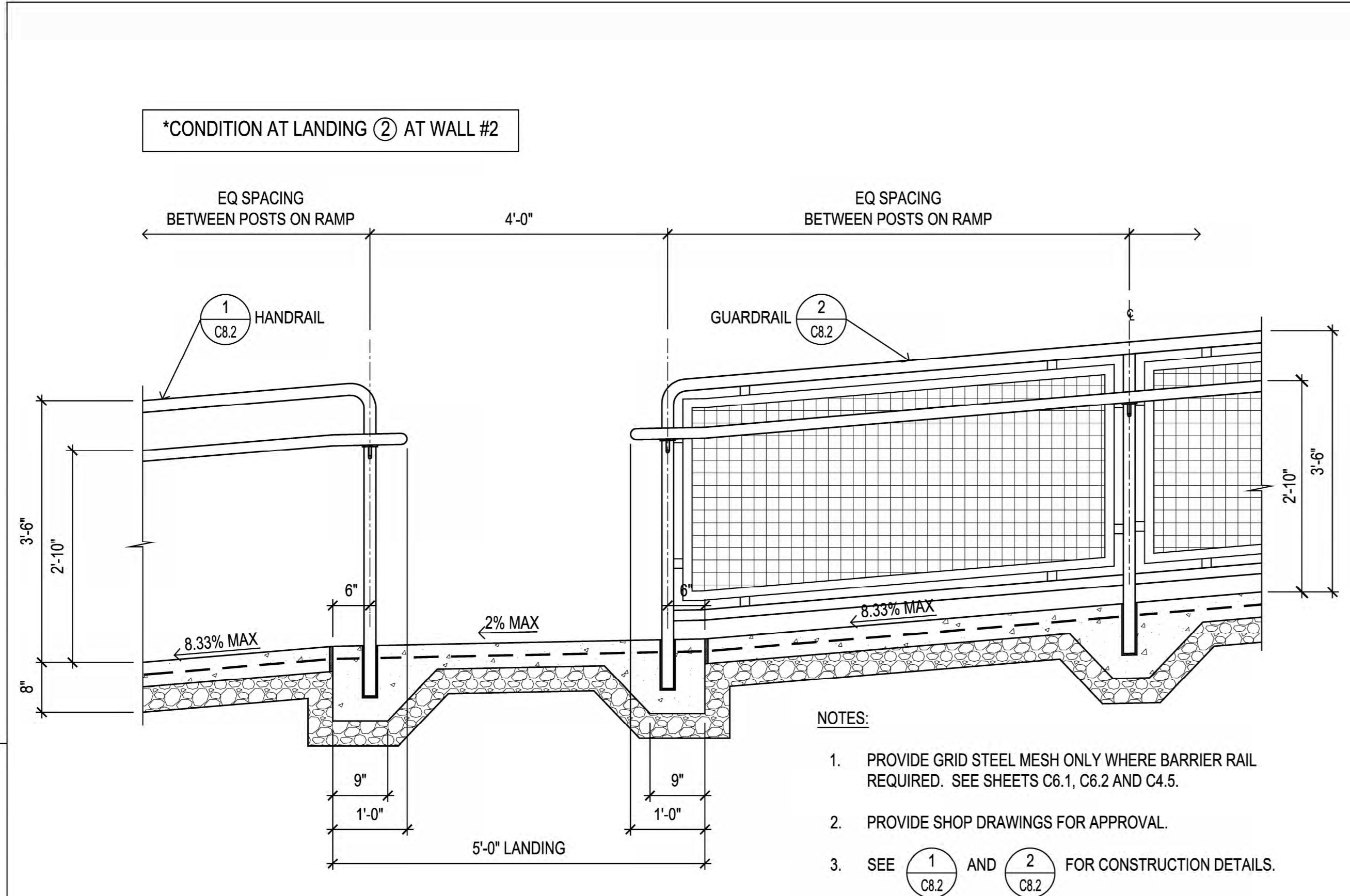

② GUARDRAIL THROUGH LANDING**
 SCALE: 3/4" = 1'-0"

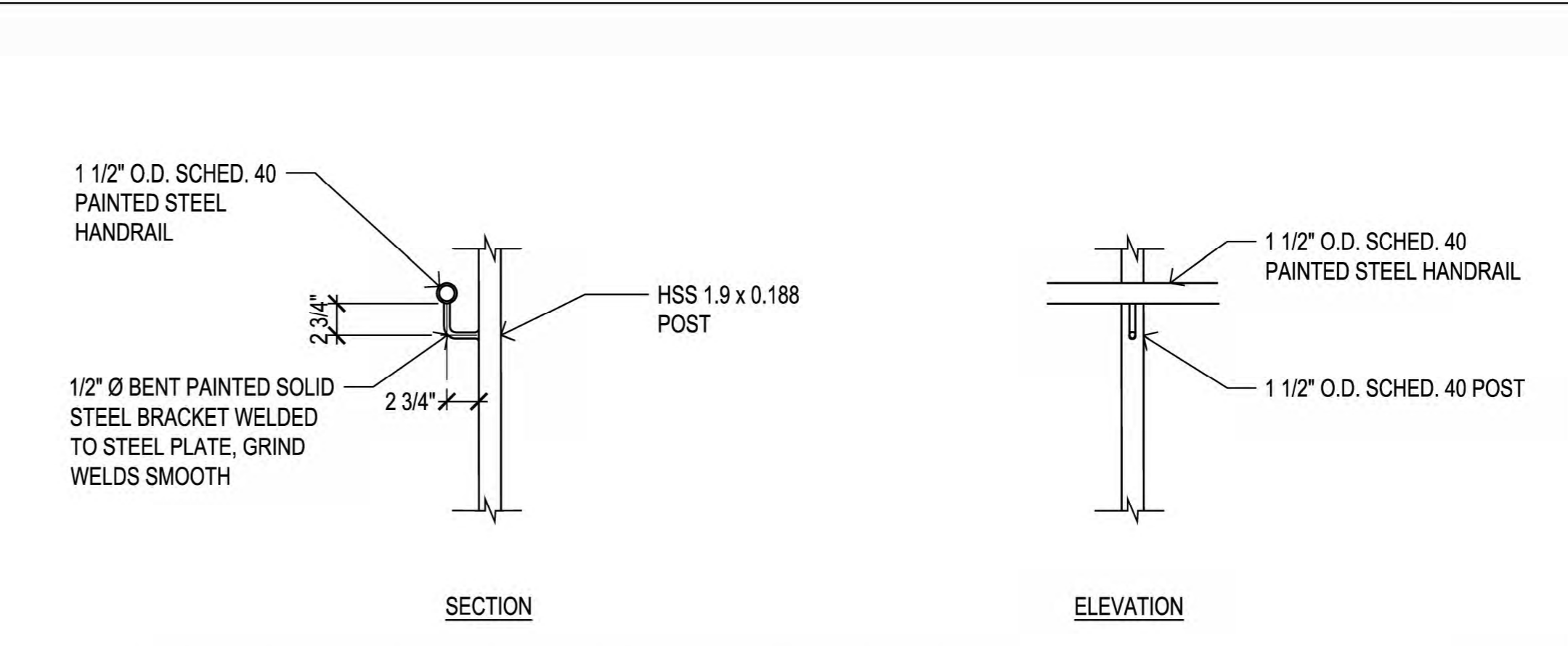

④ HANDRAIL TO POST CONNECTION
 SCALE: 1" = 1'-0"

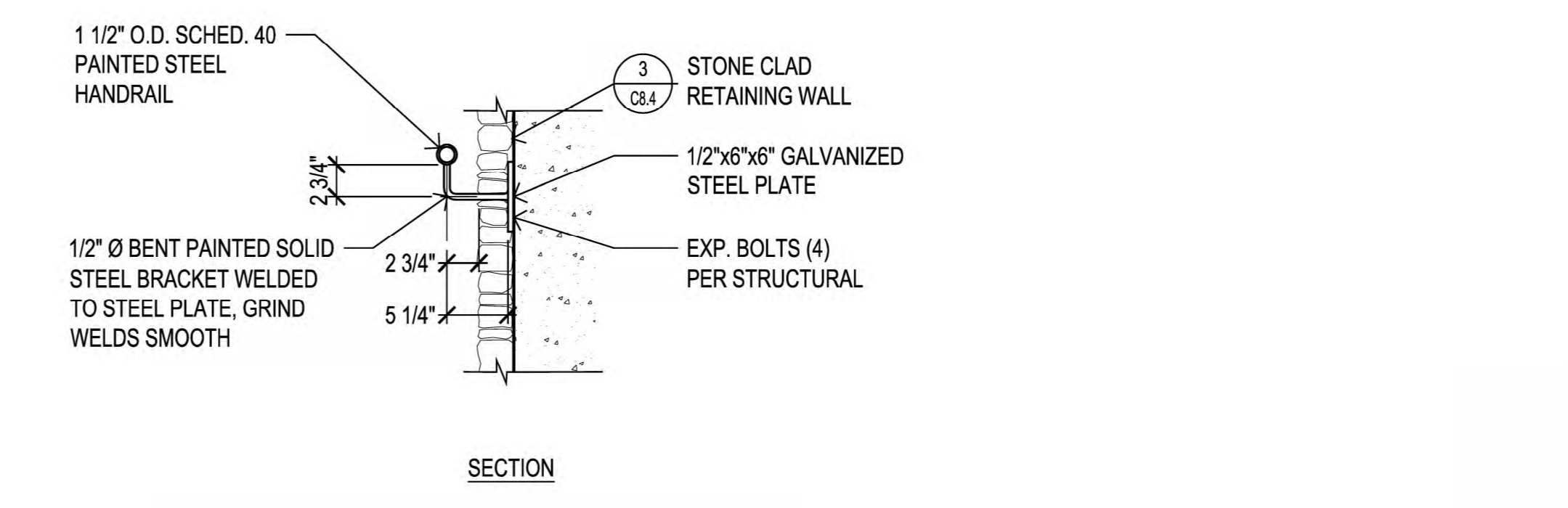

⑤ WALL MOUNTED HANDRAIL
 SCALE: 1" = 1'-0"

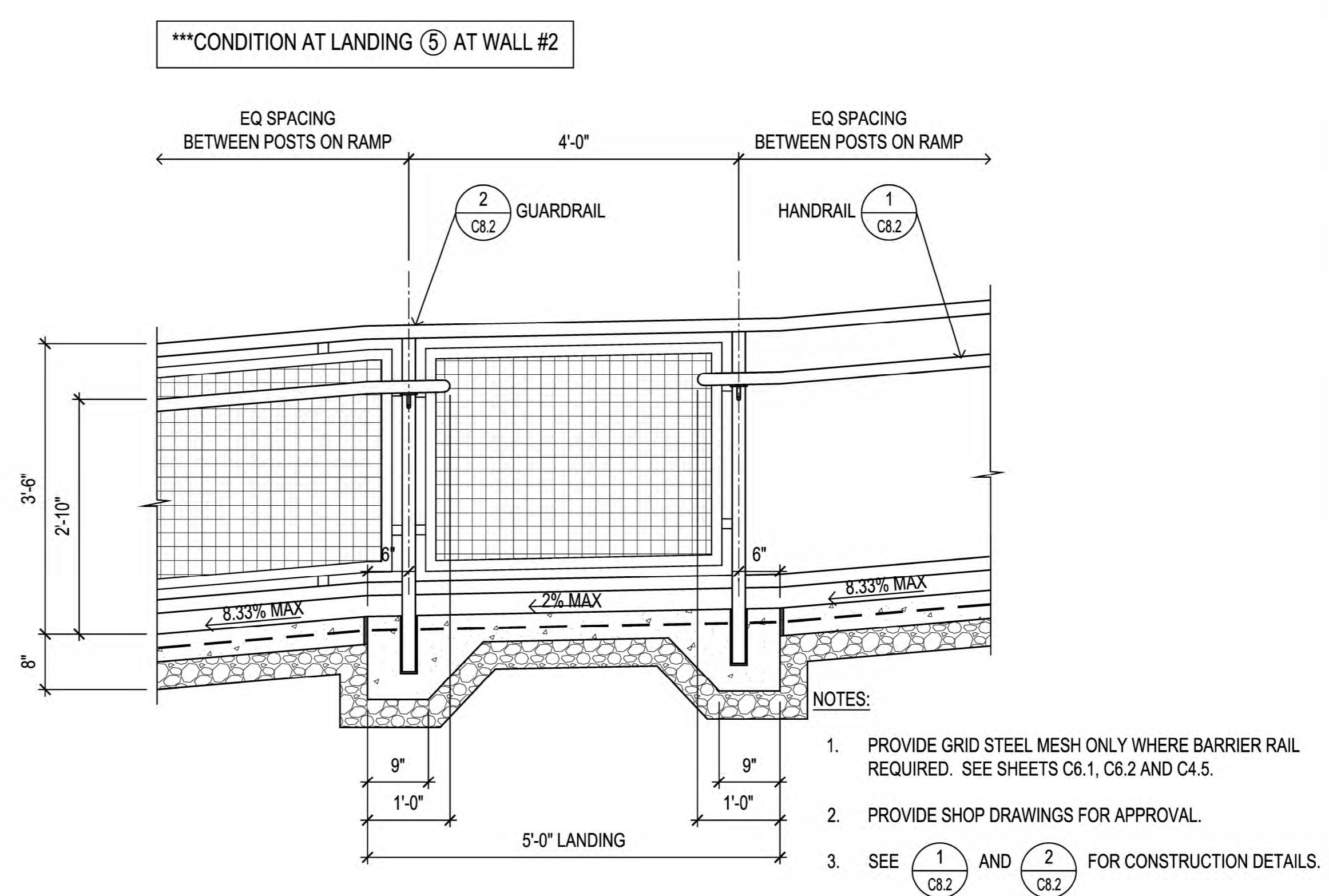

③ GUARDRAIL TO HANDRAIL CONDITION***
 SCALE: 3/4" = 1'-0"

PROJECT INFORMATION

SOUND TO OLYMPIC TRAIL
 SR 305 CORRIDOR
 ENHANCEMENTS
 PHASE 2 & PHASE 4

REVISION BLOCK

NO. DATE BY REVISION

SEC. 26, T. 25 N., R. 2 E., W. M.,
 CITY OF BAINBRIDGE ISLAND, KITSAP COUNTY, WA.

| | |
|--------------------|-----------|
| Scale: | |
| Horiz: | |
| Vert: | |
| Coordinate System: | |
| Vertical Datum: | |
| Designed By: | C RECKORD |
| Drawn By: | M STEWART |
| Inspected By: | |
| W.O. No.: | |
| Issue Date: | |

CONSTRUCTION DETAILS

MacLeod Reckord PLLC
 110 Prefontaine Place South, Suite 600
 Seattle, Washington 98104
 P 206-323-7919
 F 206-323-9242

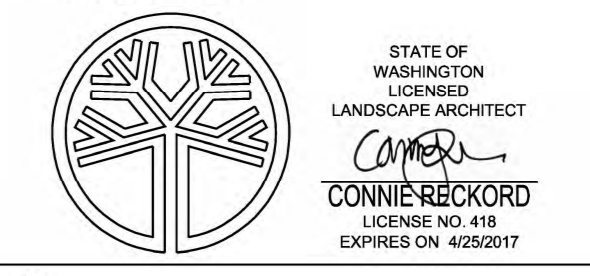

Drawing No. **C8.3**

Path: Z:\Projects\Sound to Olympics Trail Bainbridge\CAD Documents\Working\STO_DETAILS.dwg
 Plot Date: 10/19/2016 8:43 AM
 Cad User: Arielle Fairina-Williams

| | | | | | | | | | | | | | | |
|-----------|----------------|-----------|-------------|----------|--------------|-------|-------------------|---------------|------------------|-----------------------|-----|----------------|-----------------|-------|
| Filename: | XREF Filename: | Drawn By: | Checked By: | Section: | Surveyed By: | Date: | Control Monument: | Field Bk./Pg: | Recorded Survey: | Kitsap County Auditor | AF- | Vol./Bk./Page: | Constructed By: | Date: |
|-----------|----------------|-----------|-------------|----------|--------------|-------|-------------------|---------------|------------------|-----------------------|-----|----------------|-----------------|-------|

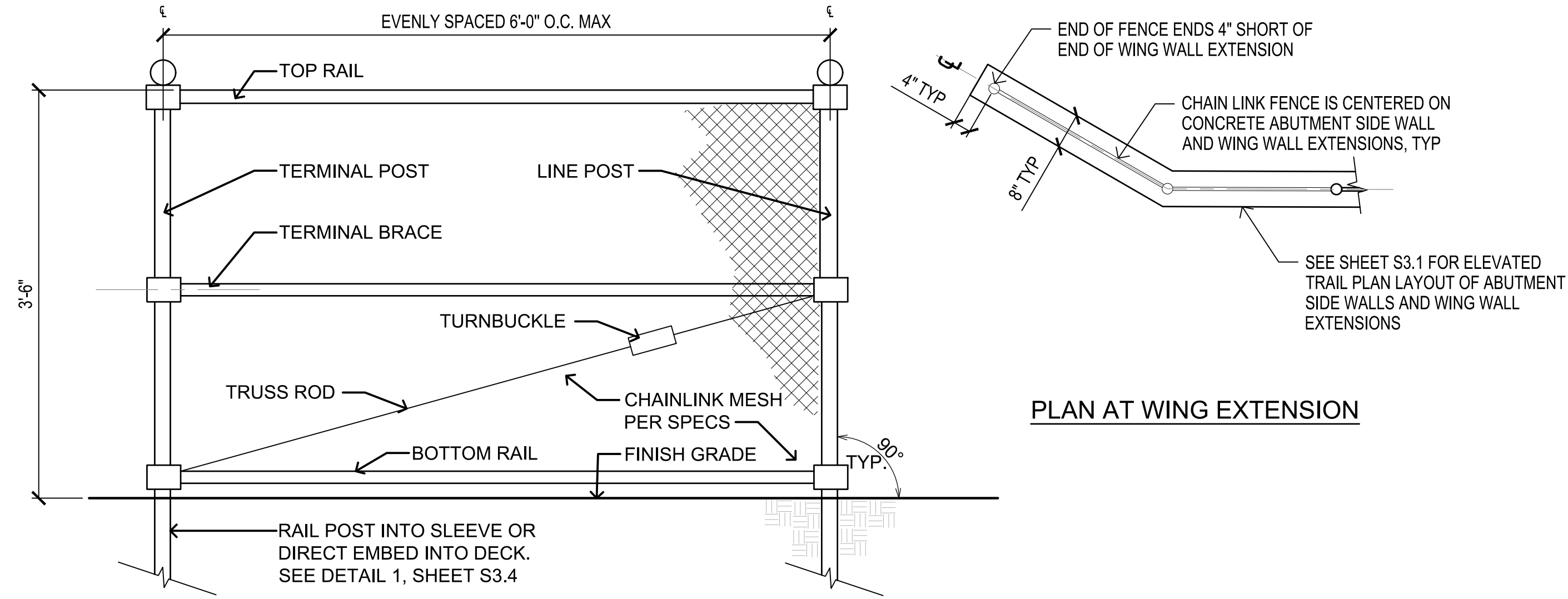

NOTES:
 PROVIDE VINYL COATED CHAINLINK FENCE AND POSTS PER SPECIFICATION, FULL LENGTH OF ELEVATED STRUCTURE BOTH SIDES, INCLUDING ABUTMENT SIDE WALLS AND WING WALL EXTENSIONS. PROVIDE SHOP DRAWINGS FOR APPROVAL.



**PUBLIC WORKS
 ENGINEERING
 DEPARTMENT**

PROJECT INFORMATION

**SOUND TO OLYMPIC TRAIL
 SR 305 CORRIDOR
 ENHANCEMENTS
 PHASE 2 & PHASE 4**

REVISION BLOCK

| NO. | DATE | BY | REVISION |
|-----|------|----|----------|
| | | | |
| | | | |
| | | | |
| | | | |
| | | | |
| | | | |
| | | | |
| | | | |
| | | | |

SEC. 26 , T. 25 N., R. 2 E., W. M.,
 CITY OF BAINBRIDGE ISLAND, KITSAP COUNTY, WA.

Scale:
 Horiz:
 Vert:

Coordinate System:

Vertical Datum:

Designed By:
 C RECKORD

Drawn By:
 M. S. WENENKO

Inspected By:

W.O. No.:

Issue Date:

CONSTRUCTION DETAILS

**MacLeod
 Reckord PLLC**
 110 Prefontaine Place South, Suite 600
 Seattle, Washington 98104
 P 206-323-7919
 F 206-323-9242

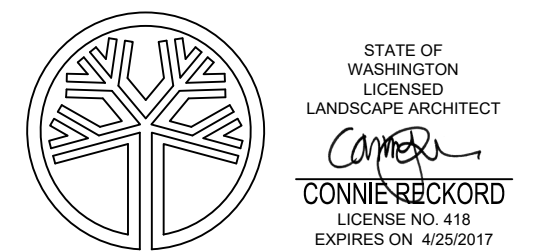

Drawing No. **C8.6**

Sheet No. **43** of **60**

Path: Z:\114000-114400\114363 (Sound to Olympics Trail Ph II)\CAD\Design\04-TRAIL-TC.dwg
 Plot Date: 10/17/2016 10:18 AM
 File Name: XREF File Name:

Drawn By: _____
 Checked By: _____
 Section: _____
 Surveyed By: _____
 Date: _____
 Control Monument: _____
 Field Bk/Pg: _____
 Recorded Survey: _____
 K (Tesp) County Auditor
 AF- _____
 Vo/Bk Page _____
 Constructed By: _____
 Date: _____

NOTES

1. CONTROLS SHOWN ARE FOR PEDESTRIAN TRAFFIC ONLY.
2. A 60" PATH WIDTH SHOULD BE MAINTAINED (48" IS THE MINIMUM).
3. CONTACT AND COORDINATE IMPACTED TRANSIT AGENCIES PRIOR TO IMPLEMENTING ANY CLOSURES.
4. SEE SHEET TC-52 FOR TEMPORARY PEDESTRIAN RAMP DETAILS.
5. ADA PEDESTRIAN FACILITIES MUST BE MAINTAINED. SEE STANDARD SPECIFICATION 1-10.2(1)B.
6. TEMPORARY PEDESTRIAN PUSH BUTTONS SHALL BE PLACED ON THE DIVERTED PATH WHEN EXISTING BUTTONS ARE NOT ACCESSIBLE TO PEDESTRIANS.

NO PARKING R8-3 24" x 30" R/W
 INSTALL ON TYPE 2 BARRICADES THROUGHOUT THE WORK AREA 24 HOURS PRIOR TO IMPLEMENTING TRAFFIC CONTROL. PRIOR NOTIFICATION OF LOCAL LAW ENFORCEMENT REQUIRED.

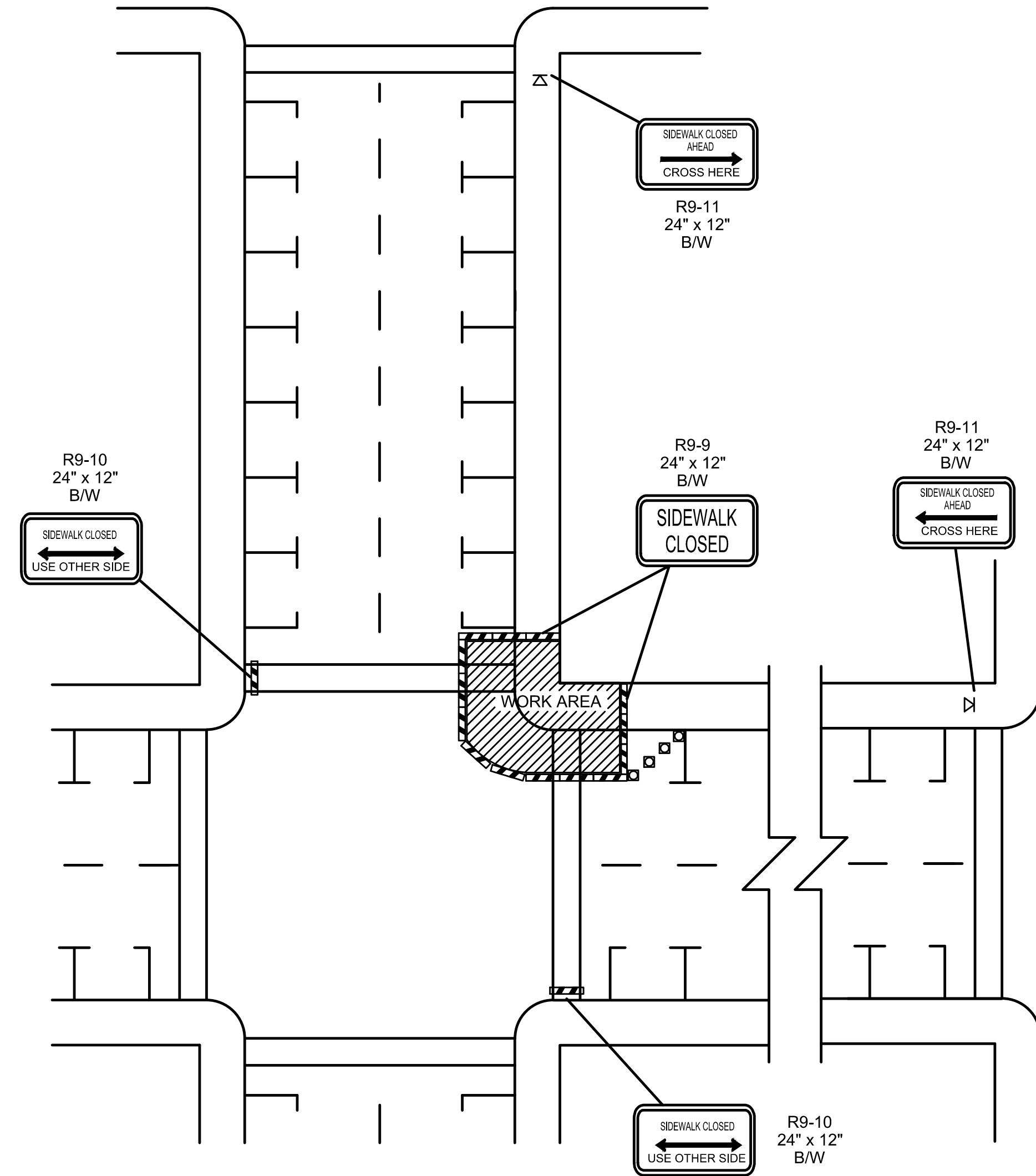
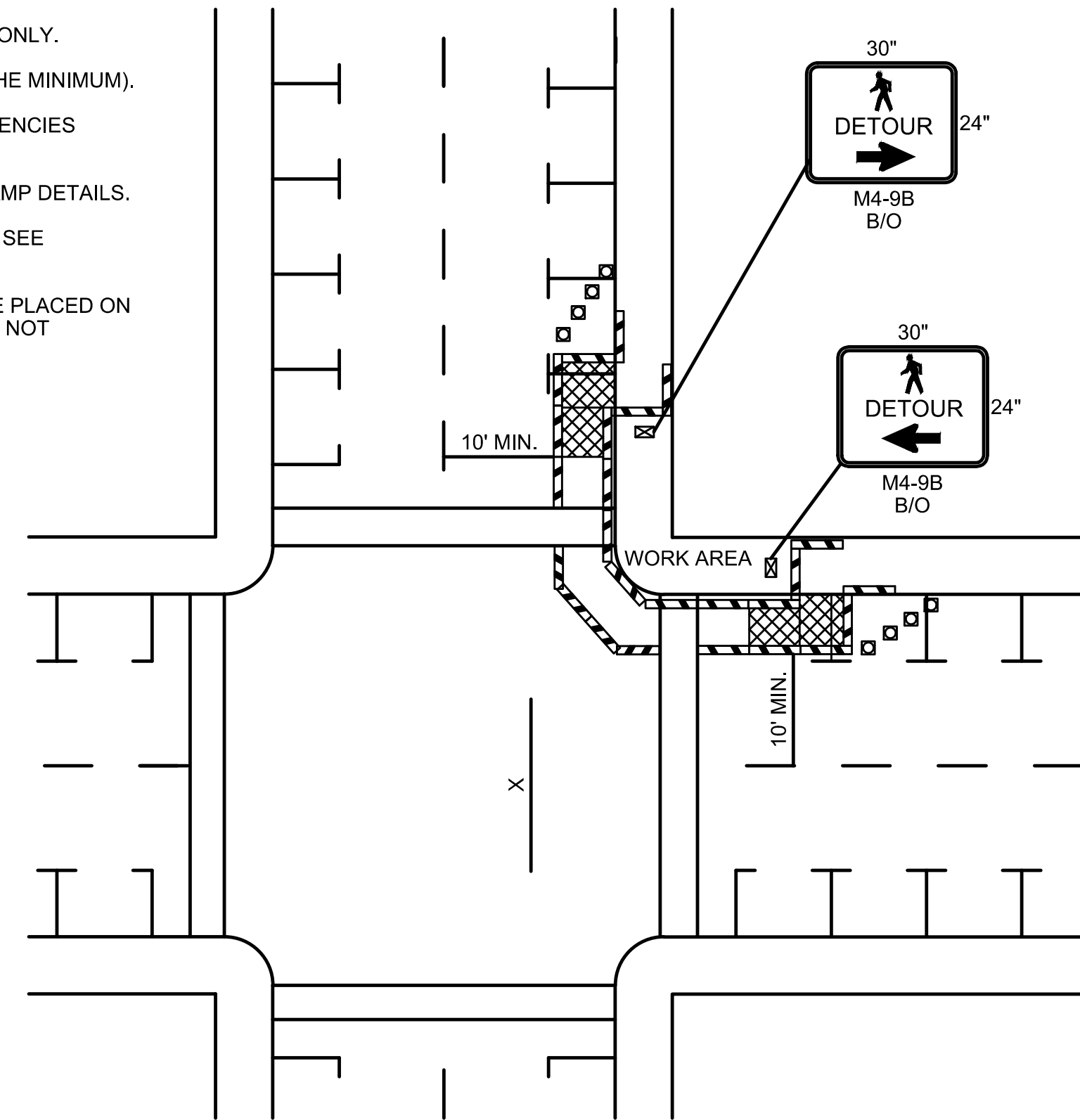

- LEGEND**
- ⊠ TEMPORARY SIGN LOCATION
 - ▣ CHANNELIZING DEVICES
 - ▨ PEDESTRIAN CHANNELIZING DEVICES
 - TEMPORARY PEDESTRIAN RAMP FOR SIDEWALKS

INTERSECTION PEDESTRIAN TRAFFIC CONTROL
 NOT TO SCALE



CITY OF BAINBRIDGE ISLAND
 280 Madison Avenue N
 Bainbridge Island, WA
 206-842-2016

**PUBLIC WORKS
 ENGINEERING
 DEPARTMENT**

PROJECT INFORMATION

SOUND TO OLYMPICS TRAIL/
 SR 305 CORRIDOR
 ENHANCEMENTS,
 PHASE 2 & PHASE 4

REVISION BLOCK

| NO. | DATE | BY | REVISION |
|-----|------|----|----------|
| | | | |
| | | | |
| | | | |
| | | | |
| | | | |
| | | | |
| | | | |
| | | | |
| | | | |

SEC.26, T.25 N., R.2E., W.M.,
 CITY OF BAINBRIDGE ISLAND, KITSAP COUNTY, WA.
 Scale:
 Horiz:
 Vert:
 Coordinate System:
 Vertical Datum:
 Designed By: **Z. GRAY**
 Drawn By: **A. MONTALVO**
 Inspected By: **R. LEIMKUEHLER**
 W.O. No.:
 Issue Date:

TRAFFIC CONTROL PLAN DETAILS

FOR REFERENCE ONLY

kpff 1601 5th Avenue, Suite 1600
 Seattle, WA 98101
 206.622.5822
 www.kpff.com

Drawing No. **C9.2**

Sheet No. **45** of **60**

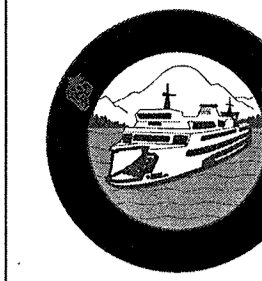

CITY OF BAINBRIDGE ISLAND
 280 Madison Avenue N
 Bainbridge Island, WA
 206-842-2016

**PUBLIC WORKS
 ENGINEERING
 DEPARTMENT**

PROJECT INFORMATION

SOUND TO OLYMPIC TRAIL
 SR 305 CORRIDOR
 ENHANCEMENTS
 PHASE 2 & PHASE 4

REVISION BLOCK

| NO. | DATE | BY | REVISION |
|-----|----------|-----|---------------------|
| 1 | 12/11/15 | MMZ | UPDATED WALL DESIGN |

NO. DATE BY REVISION
 SEC. 26, T. 25N., R. 2E., W.M.,
 CITY OF BAINBRIDGE ISLAND, KITSAP COUNTY, WA.

Scale:
 Horiz:
 Vert:
 Coordinate System:
 Vertical Datum:
 Designed By:
 M. ZAWLOCKI
 Drawn By:
 M. ZAWLOCKI
 Inspected By:
 W.O. No.:
 Issue Date:

WALL 1 & 2
 PLAN, PROFILE & SECTION



N.L. Olson & Associates, Inc.
 Engineering, Planning and Surveying
 (360) 895-2350 or (360) 876-2284
 2453 Bethel Avenue, P.O. Box 637, Port Orchard, WA 98366

Drawing No. **S2.1**

Sheet No. 48 of 60

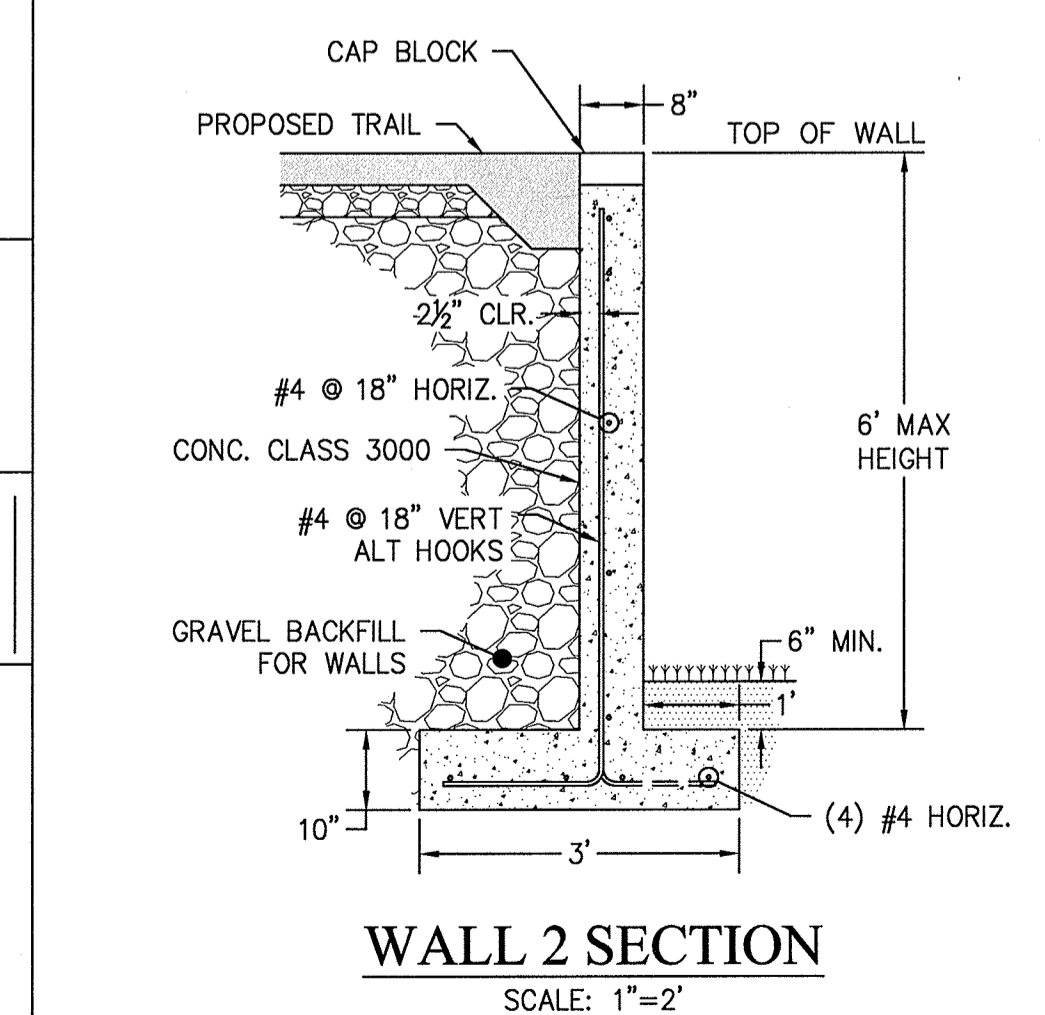
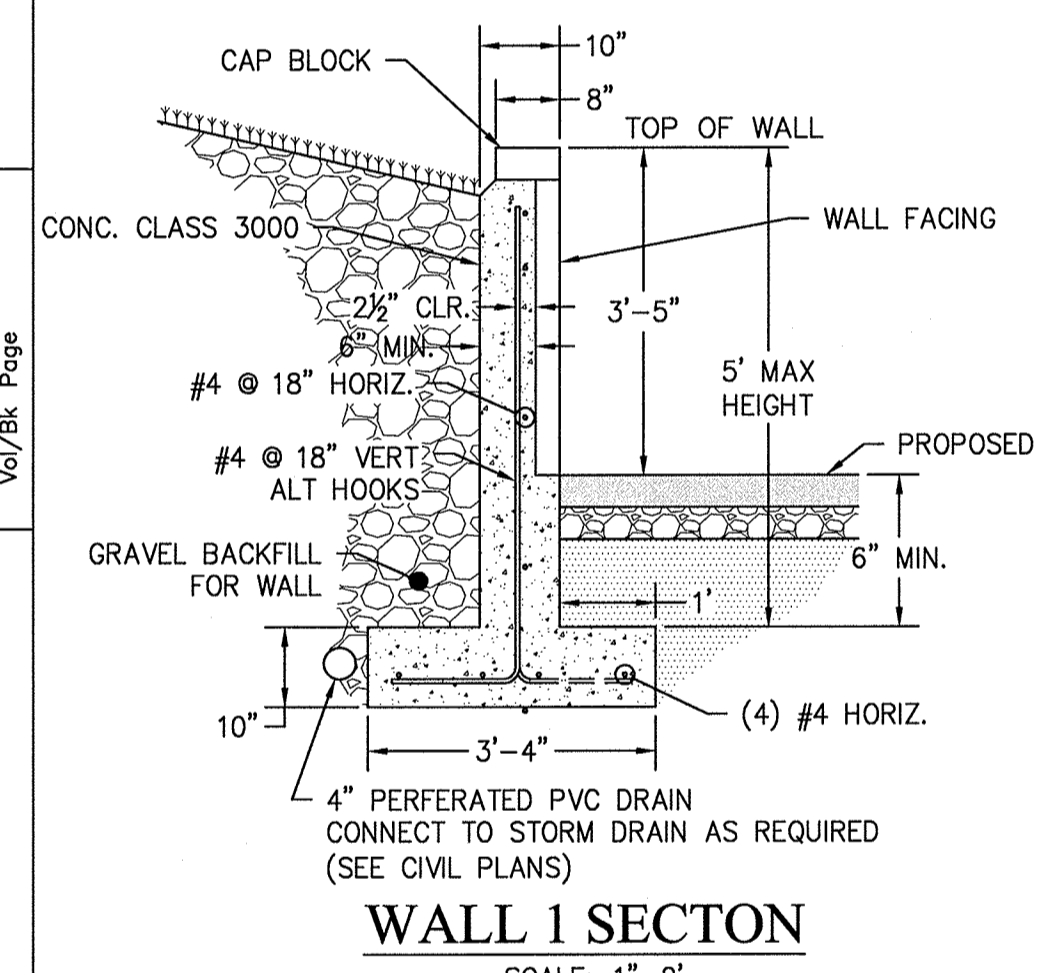
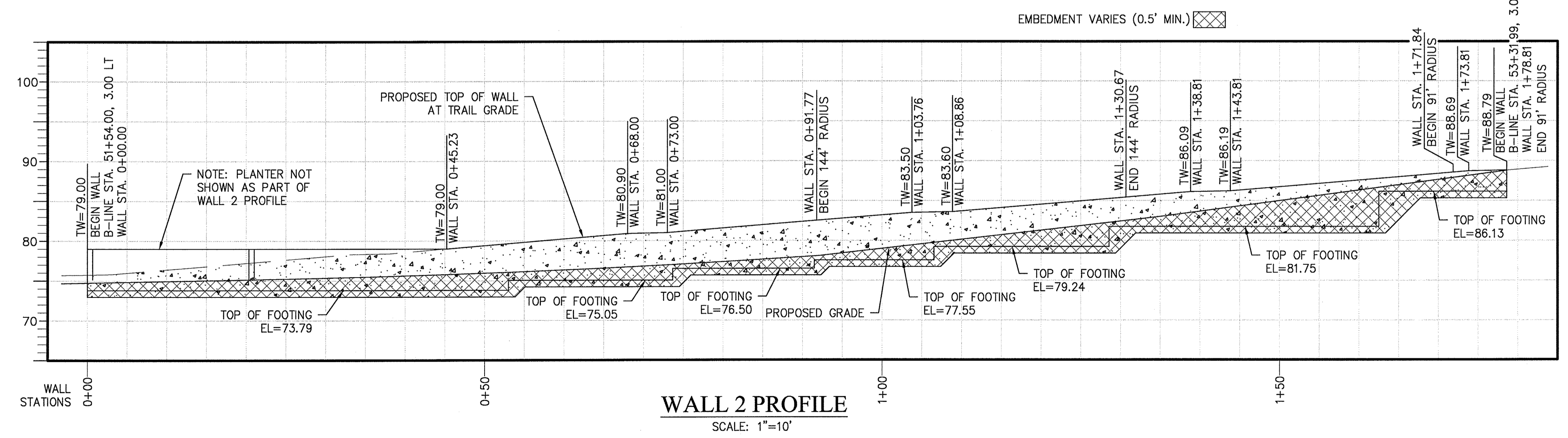
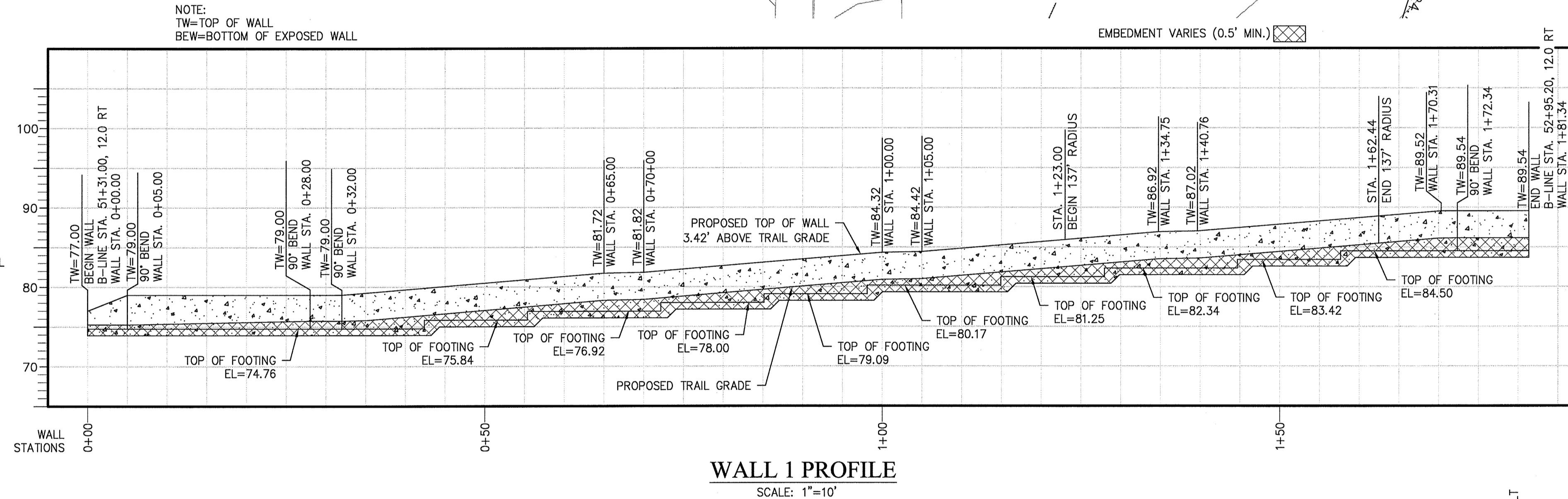
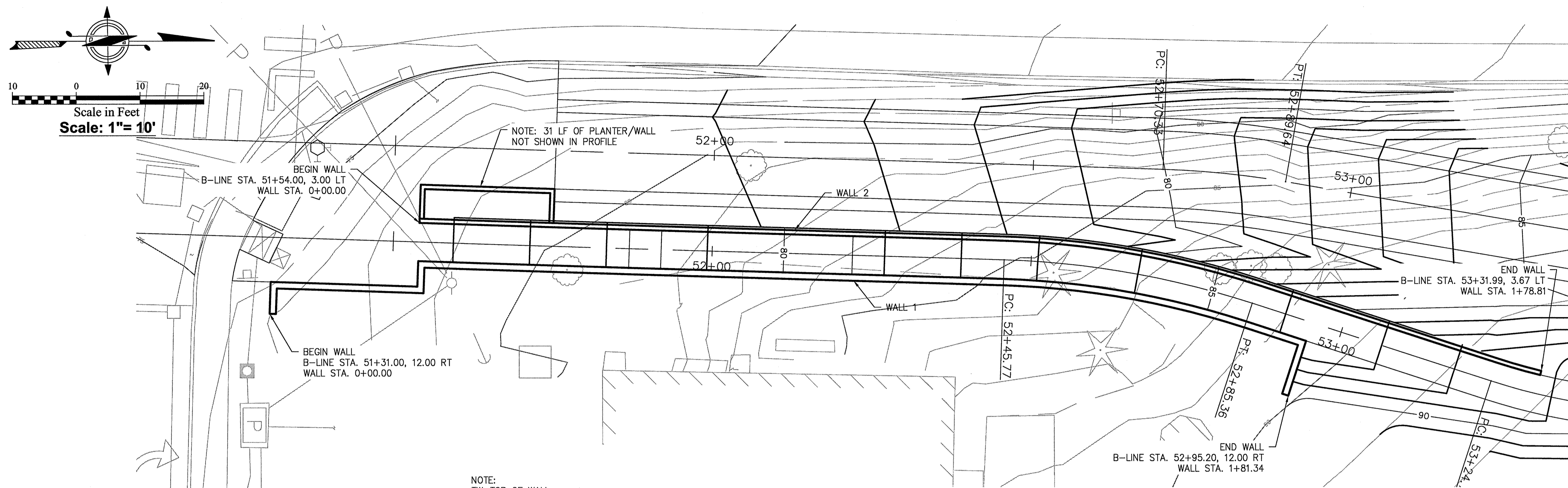

Path: I:\SERVER\AutoCAD Projects\817 WALLS\WALL PLANS & PROFILES & ELEVATED TRAIL.dwg
 Plot Date: 10/12/2016 2:56 PM
 File Name: XREF File Name:

Surveyed By: Section: Drawn By: Checked By: Constructed By: Date: Recorded Survey: Kitap County Auditor AF- Vol/Bk/Pg: Field Bk/Pg: Control Monument: Date: