

CITY OF BAINBRIDGE ISLAND
 280 Madison Avenue N
 Bainbridge Island, WA
 206-842-2016

**PUBLIC WORKS
 ENGINEERING
 DEPARTMENT**

PROJECT INFORMATION

SOUND TO OLYMPIC TRAIL
 SR 305 CORRIDOR
 ENHANCEMENTS
 PHASE 2 & PHASE 4

REVISION BLOCK

NO.	DATE	BY	REVISION

SEC. 26 , T. 25 N., R. 2E., W.M.,
 CITY OF BAINBRIDGE ISLAND, KITSAP COUNTY, WA.

Scale:
 Horiz:
 Vert:
 Coordinate System:
 Vertical Datum:
 Designed By:
 C RECKORD
 Drawn By:
 M STEWART
 Inspected By:
 W.O. No.:
 Issue Date:

ENLARGED AREA LAYOUT

**MacLeod
 Reckord** PLLC
 110 Prefontaine Place South, Suite 600
 Seattle, Washington 98104
 P 206-323-7919
 F 206-323-9242

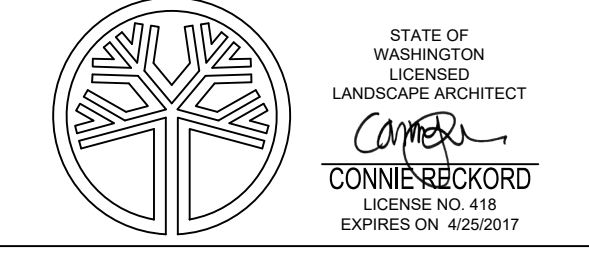

Drawing No. **C4.3**

Sheet No. 25 of 60

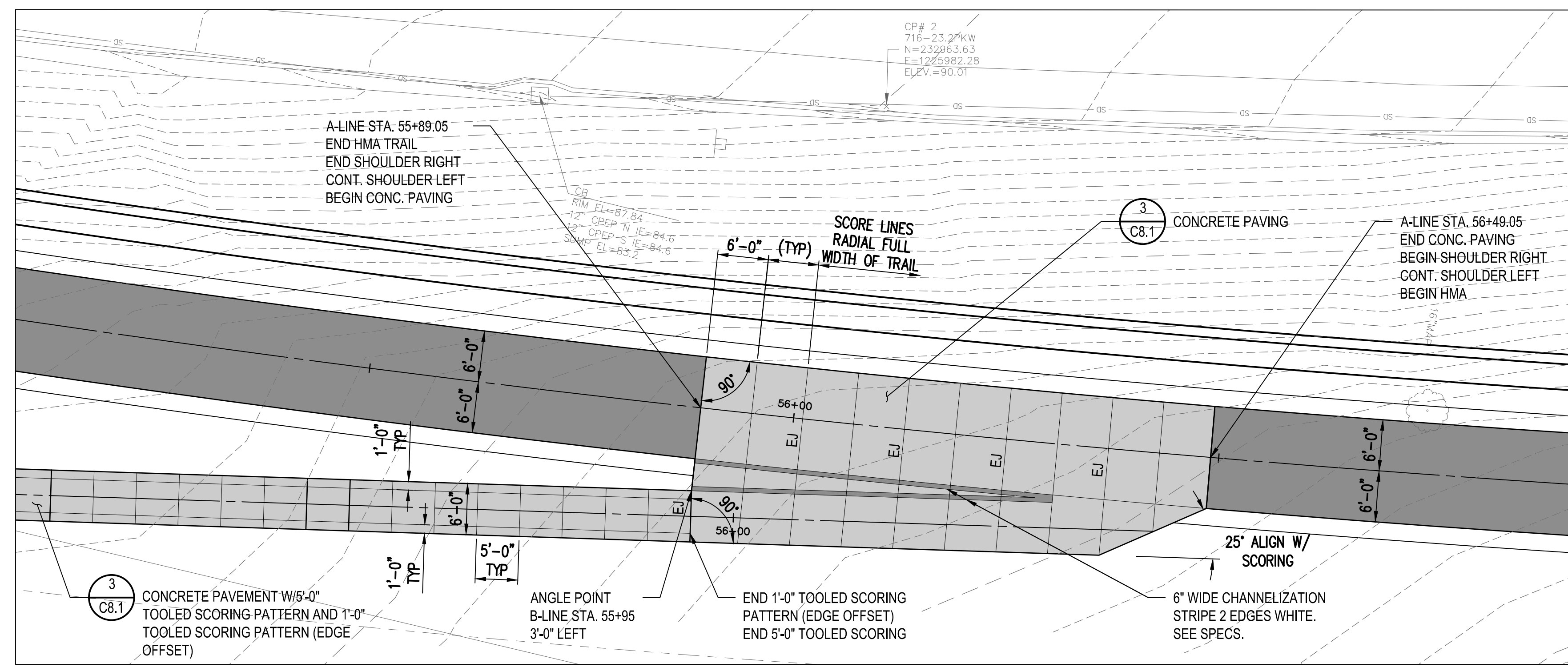

1 A/B LINE MIXING ZONE LAYOUT PLAN
 SCALE: 1" = 10'

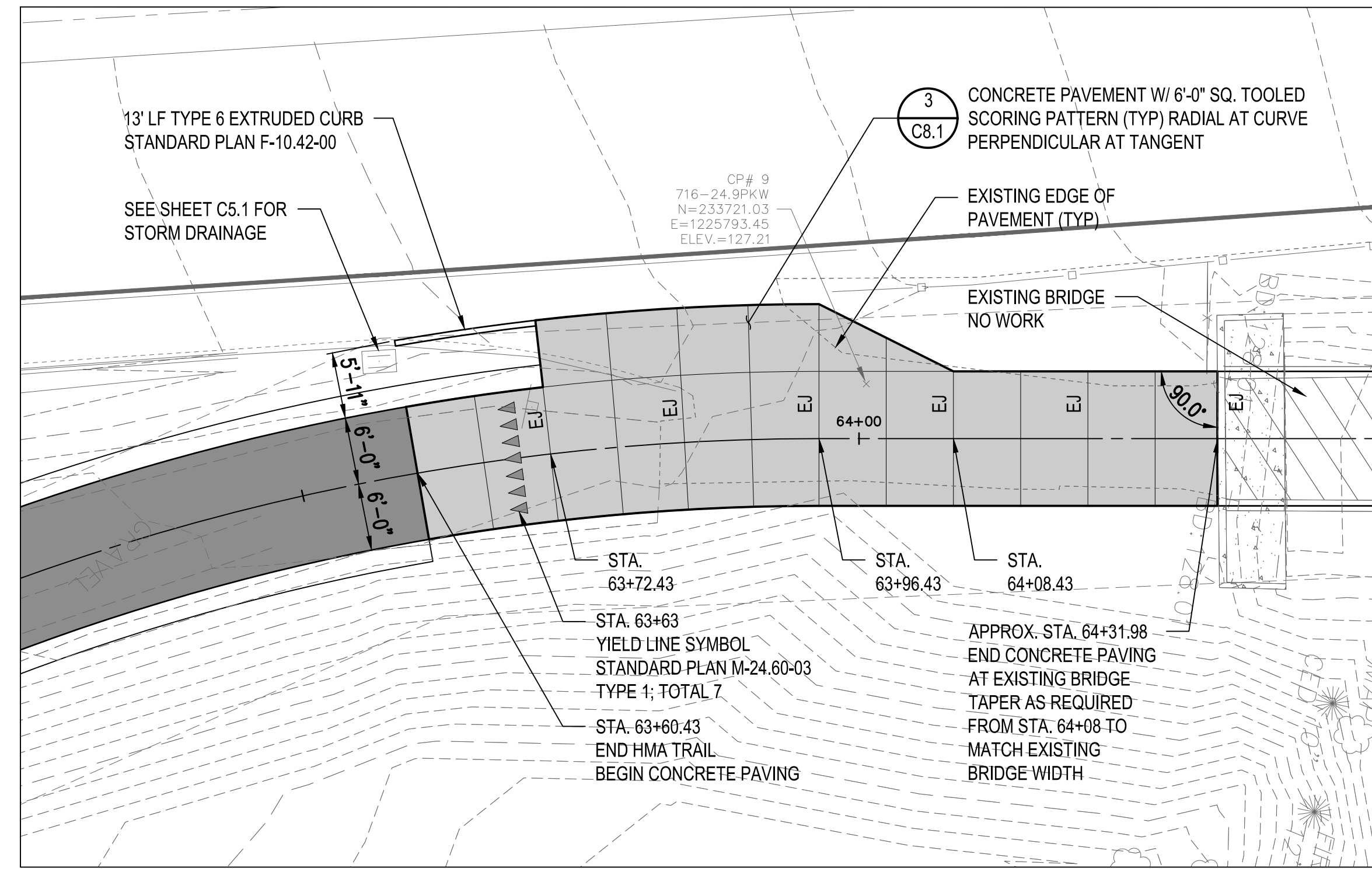

2 SOUTH END BRIDGE MIXING ZONE LAYOUT PLAN
 SCALE: 1" = 10'

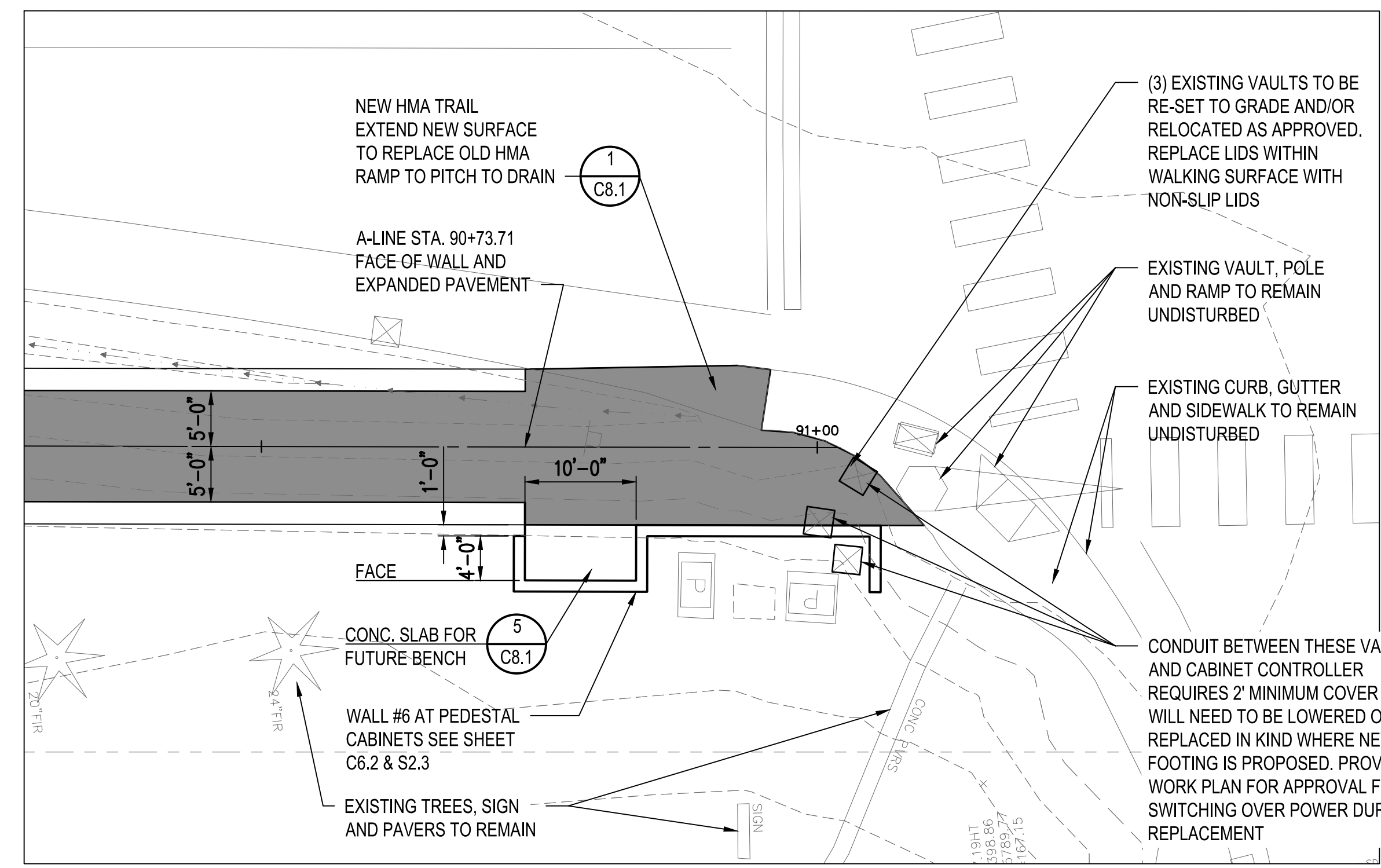

3 NORTH PLAZA LAYOUT PLAN
 SCALE: 1" = 10'

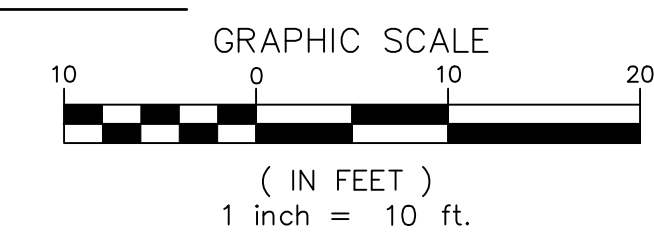

Path: Z:\Projects\Sound to Olympics Trail\Bainbridge\CAD Documents\Working\STO-PLAN PLAZA.dwg
 Plot Date: 10/19/2016 8:40 AM
 Cad User: Arielle Farina-Williams
 File Name: XREF Filename:

Constructed By: _____ Date: _____
 Recorded Survey: _____
 Kitsap County Auditor
 AF- _____
 Vol./Bk. Page _____
 Control Monument: _____
 Field Bk./Pg: _____
 Surveyed By: _____ Date: _____
 Section: _____
 Drawn By: _____ Checked By: _____

Path: Z:\114000-114400\114363 (Sound to Olympics Trail Ph II)\CADD\Design\02-TRAIL-SD.dwg
 Plot Date: 10/11/2016 11:24 AM
 Filename: XREF Filename:

Drawn By: _____
 Checked By: _____
 Section: _____
 Surveyed By: _____
 Date: _____
 Control Monument: _____
 Field Bk/Pg: _____
 Recorded Survey: _____
 Kitsap County Auditor
 AF- _____
 Vol/Bk Page _____
 Constructed By: _____
 Date: _____

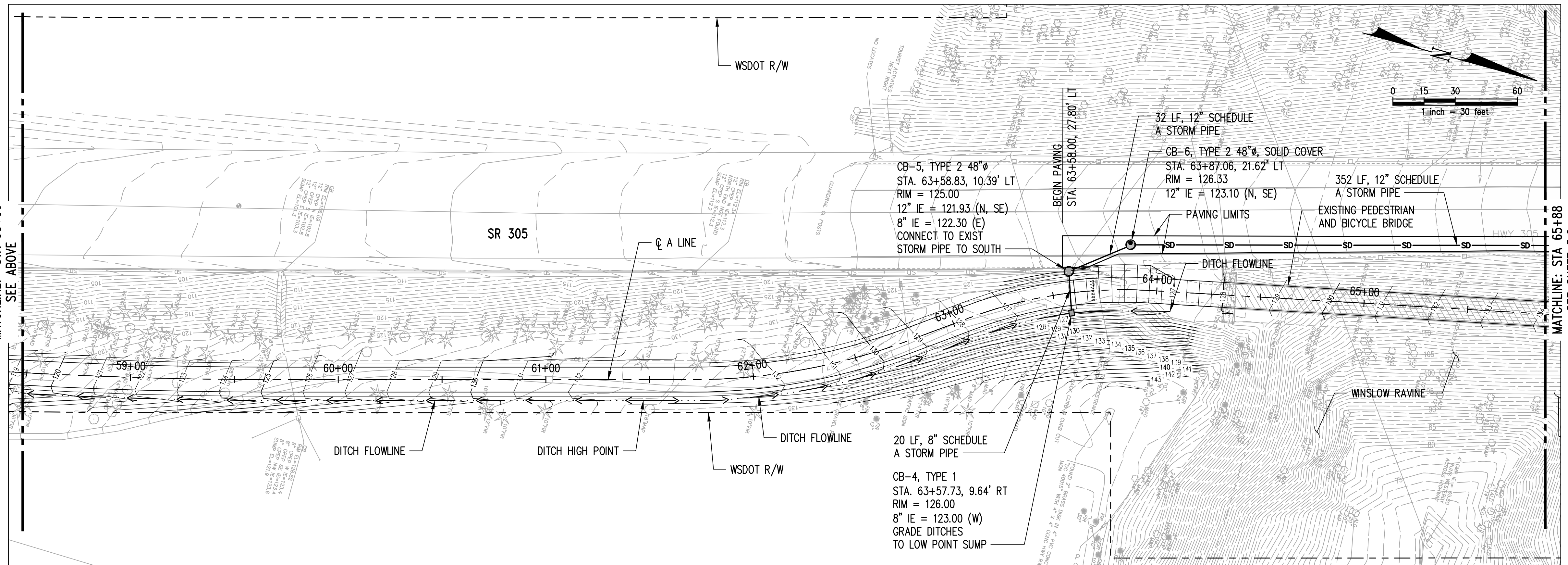
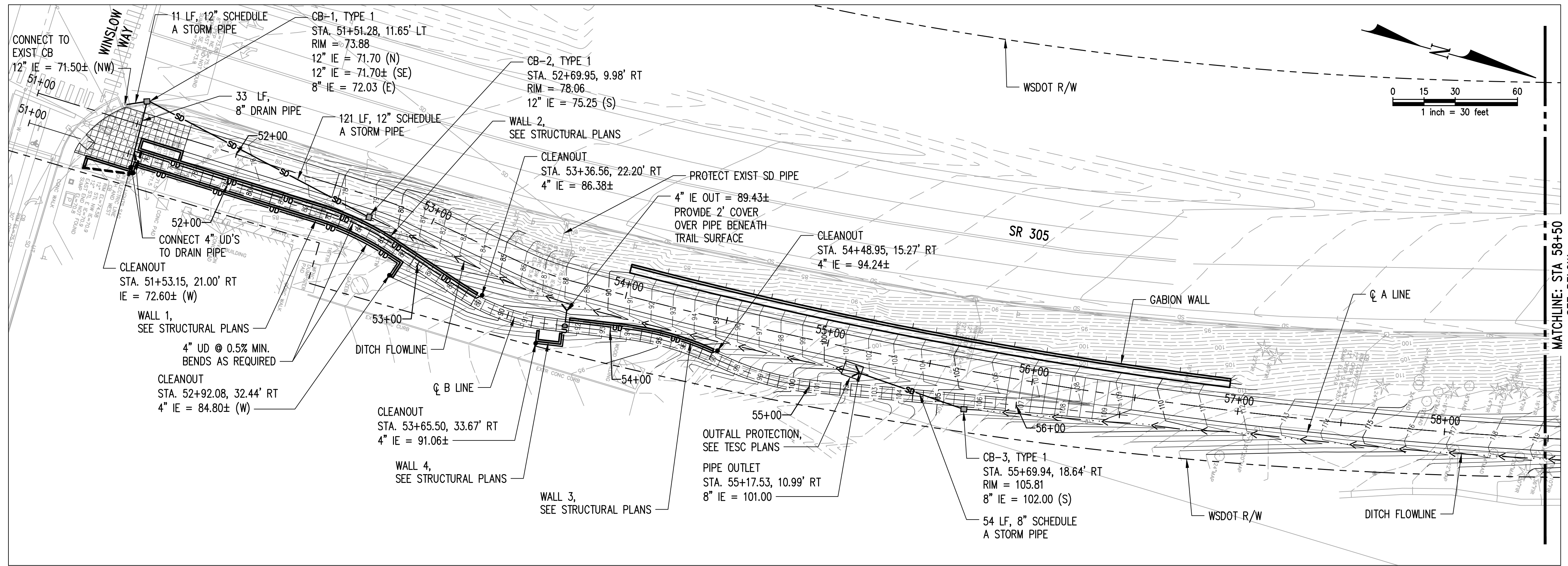

**PUBLIC WORKS
 ENGINEERING
 DEPARTMENT**

PROJECT INFORMATION

SOUND TO OLYMPICS TRAIL/
 SR 305 CORRIDOR
 ENHANCEMENTS,
 PHASE 2 & PHASE 4

REVISION BLOCK

NO.	DATE	BY	REVISION

SEC.26, T.25 N., R.2E., W.M.,
 CITY OF BAINBRIDGE ISLAND, KITSAP COUNTY, WA.
 Scale:
 Horiz:
 Vert:
 Coordinate System:
 Vertical Datum:
 Designed By: Z. GRAY
 Drawn By: A. MONTALVO
 Inspected By: R. LEIMKUEHLER
 W.O. No.:
 Issue Date:

STORM DRAIN AND
 SR 305 PAVING PLAN



kpff 1601 5th Avenue, Suite 1600
 Seattle, WA 98101
 206.622.5822
 www.kpff.com

Drawing No. **C5.1**

Sheet No. 28 of 60

Drawn By:	Checked By:	Section:	Surveyed By:	Control Monument:	Recorded Survey:	Constructed By:
			Angel Montalvo		Kitsap County Auditor	
Date:	Date:			Field Bk/Pg:	AF-	Date:
				Vol/Bk Page		

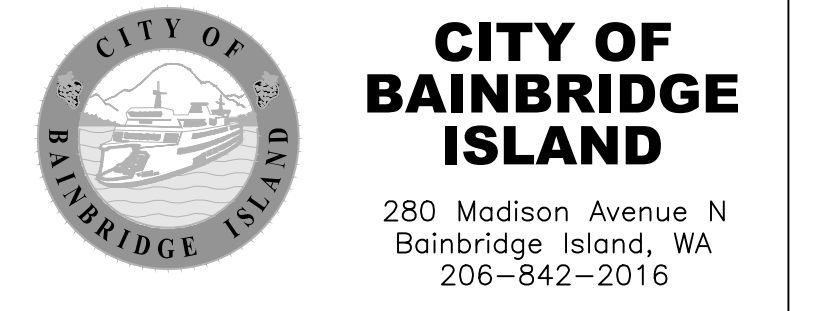
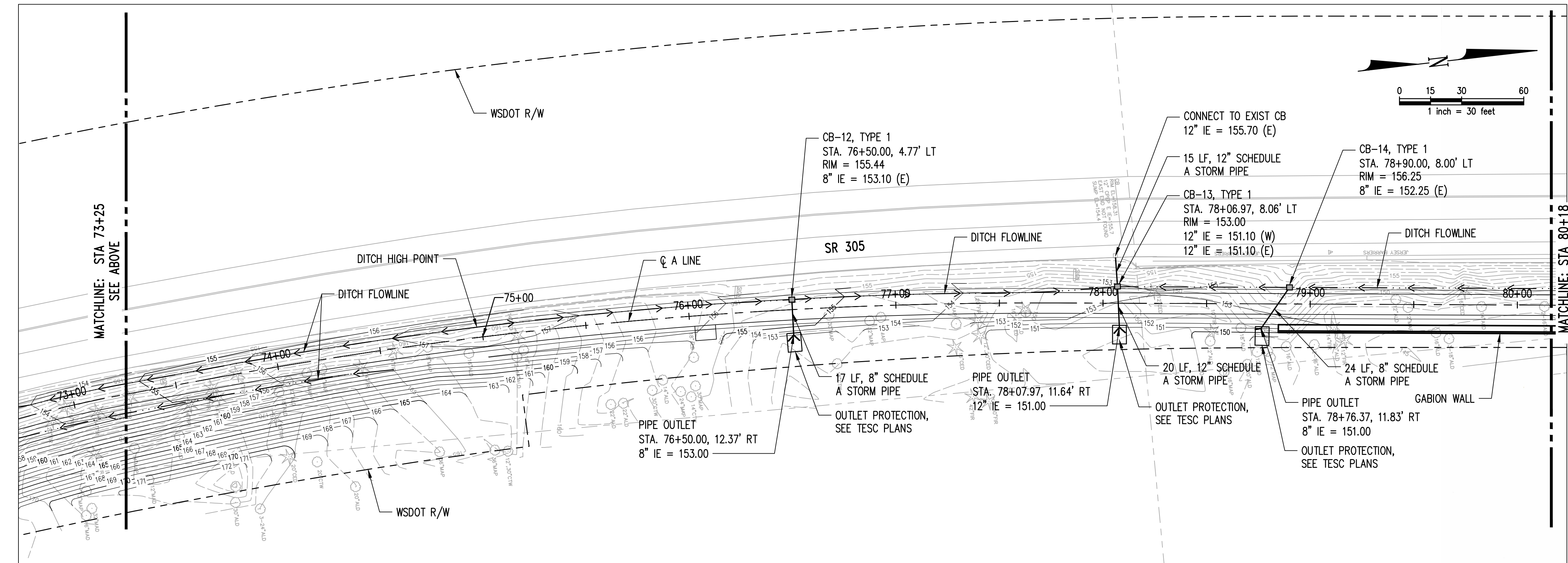
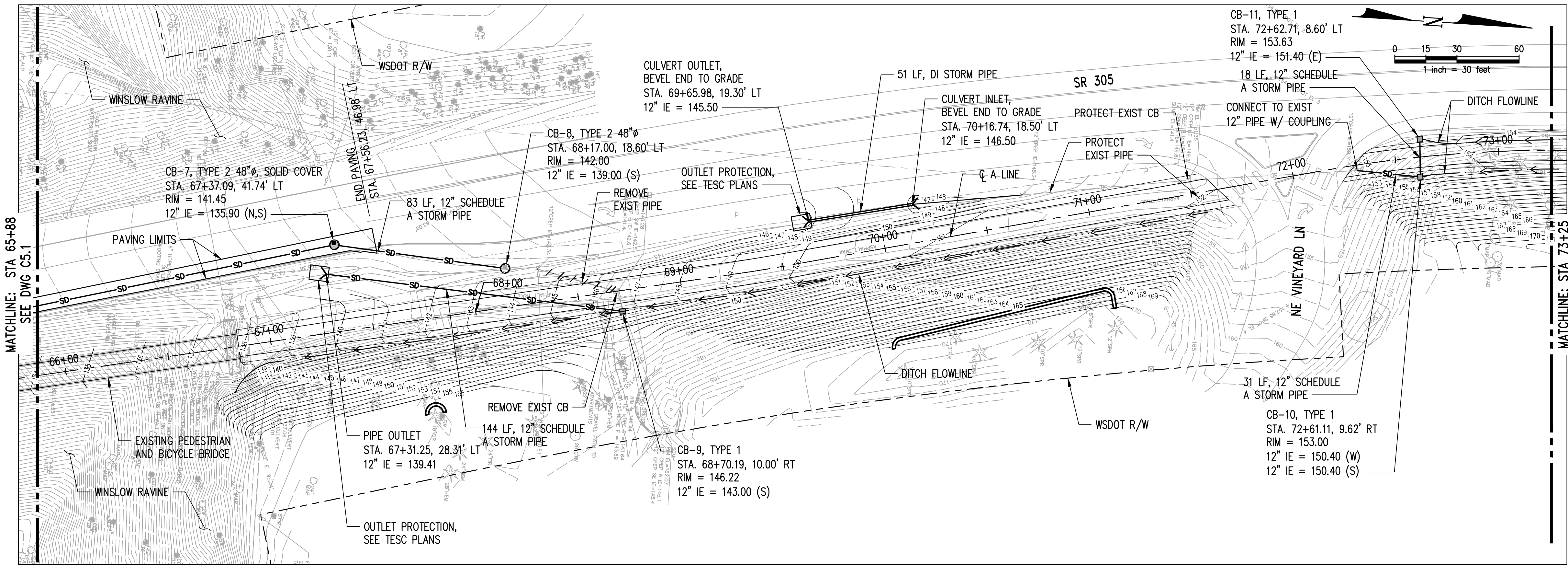

**PUBLIC WORKS
ENGINEERING
DEPARTMENT**

PROJECT INFORMATION

SOUND TO OLYMPICS TRAIL/
SR 305 CORRIDOR
ENHANCEMENTS,
PHASE 2 & PHASE 4

REVISION BLOCK

NO.	DATE	BY	REVISION

SEC.26, T.25 N., R.2E., W.M.,
CITY OF BAINBRIDGE ISLAND, KITSAP COUNTY, WA.

Scale:
Horiz:
Vert:
Coordinate System:
Vertical Datum:

Designed By: Z. GRAY
 Drawn By: A. MONTALVO
 Inspected By: R. LEIMKUHLER
 W.O. No.:
 Issue Date:

STORM DRAIN AND
SR 305 PAVING PLAN

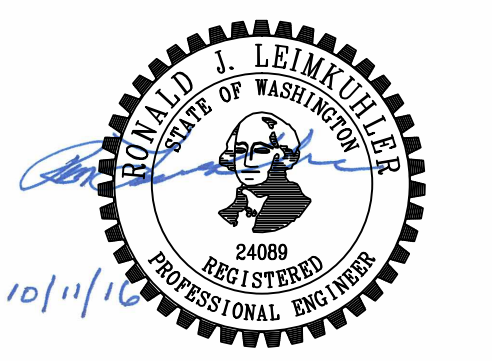

kpff 1601 5th Avenue, Suite 1600
Seattle, WA 98101
206.622.5822
www.kpff.com

Drawing No. **C5.2**

Sheet No. 29 of 60

Path: Z:\114000-114400\114363 (Sound to Olympics Trail Ph II)\CADD\Design\03-TRAIL-DT.dwg
 Plot Date: 10/11/2016 11:25 AM
 File Name: XREF File Name:

Drawn By:	Checked By:	Surveyed By:	Control Monument:	Recorded Survey:	Constructed By:
			Field Bk/Pg:	Kitsap County Auditor	Date:
				AF-	
				Vol/Bk Page	

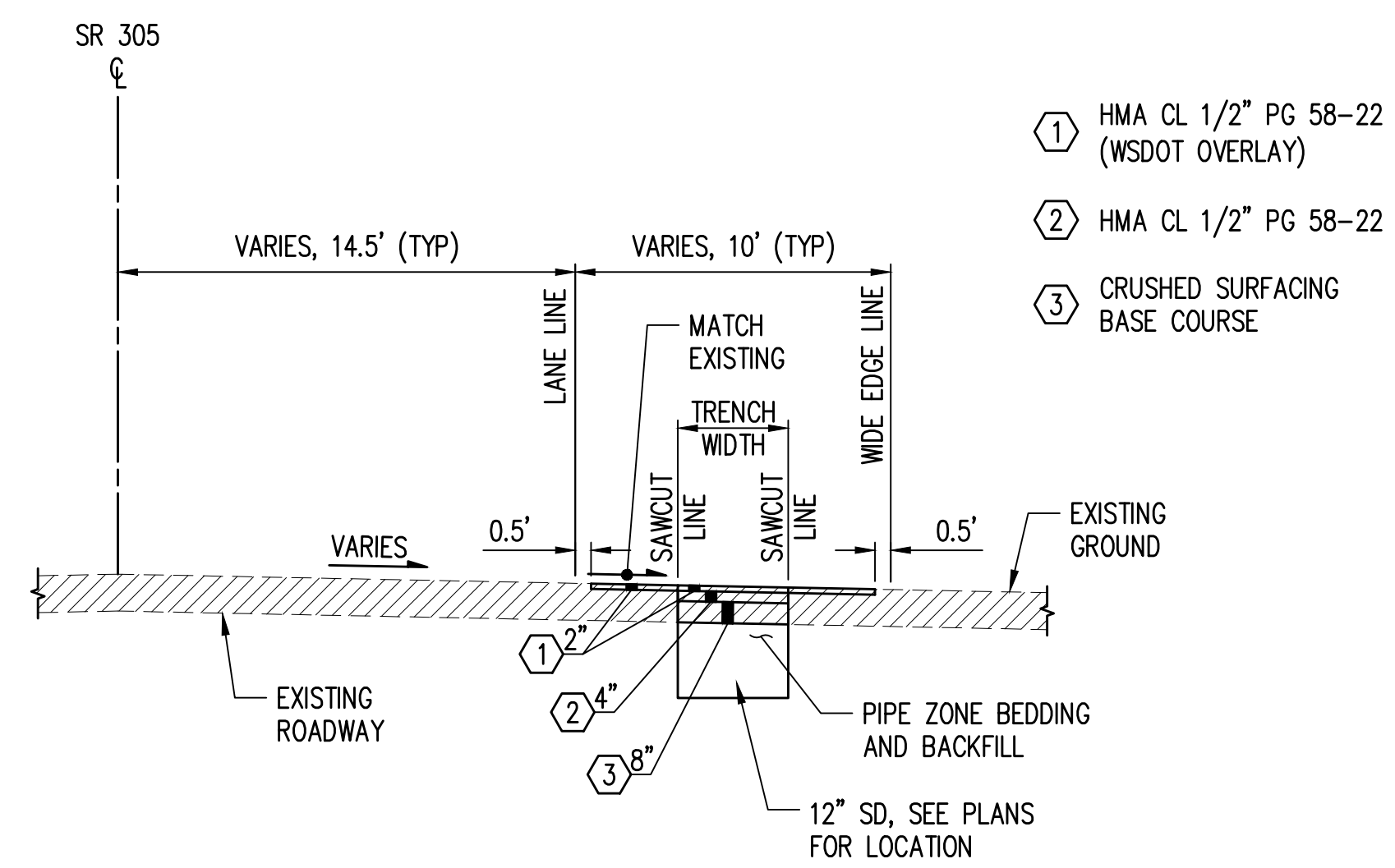

SR 305 PAVEMENT RESTORATION SECTION A
 1" = 5'
 STA. 63+58.00 TO STA. 67+56.23



CITY OF BAINBRIDGE ISLAND
 280 Madison Avenue N
 Bainbridge Island, WA
 206-842-2016

**PUBLIC WORKS
 ENGINEERING
 DEPARTMENT**

PROJECT INFORMATION

SOUND TO OLYMPICS TRAIL/
 SR 305 CORRIDOR
 ENHANCEMENTS,
 PHASE 2 & PHASE 4

REVISION BLOCK

NO.	DATE	BY	REVISION

SEC. 26, T. 25 N., R. 2 E., W. M.,
 CITY OF BAINBRIDGE ISLAND, KITSAP COUNTY, WA.

Scale:
 Horiz:
 Vert:
 Coordinate System:
 Vertical Datum:
 Designed By: Z. GRAY
 Drawn By: A. MONTALVO
 Inspected By: R. LEIMKUEHLER
 W.O. No.:
 Issue Date:

PAVING DETAIL

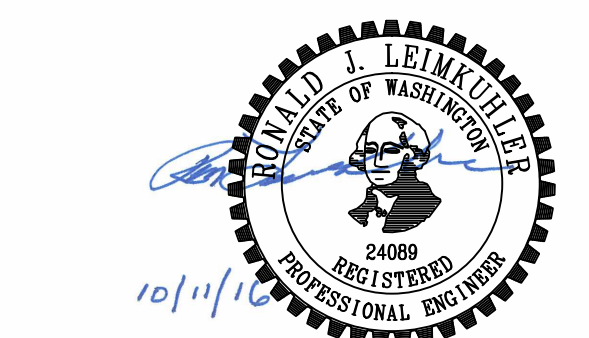

kpff 1601 5th Avenue, Suite 1600
 Seattle, WA 98101
 206.622.5822
 www.kpff.com

Drawing No. **C5.5**

Sheet No. 32 of 60

Path: Z:\Projects\Sound to Olympics Trail Bainbridge\CAD Documents\Working\STO-SECTIONS.dwg
 Plot Date: 10/19/2016 8:42 AM
 Cad User: Arielle Farina-Williams

Drawn By: _____
 Checked By: _____
 Section: _____
 Surveyed By: _____
 Date: _____
 Control Monument: _____
 Field Bk./Pg: _____
 Recorded Survey: _____
 Kitsap County Auditor
 AF- _____
 Vol./Bk./Page: _____
 Constructed By: _____
 Date: _____

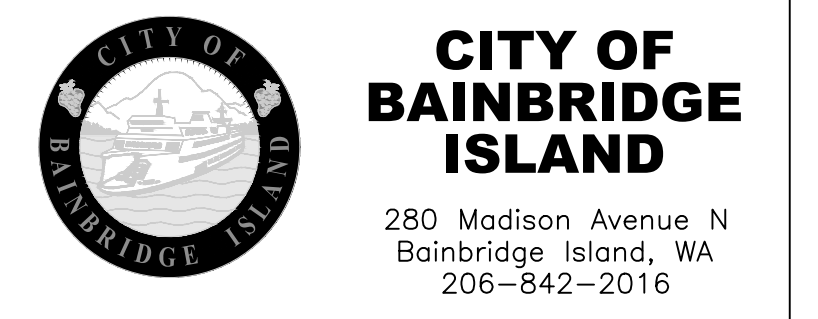
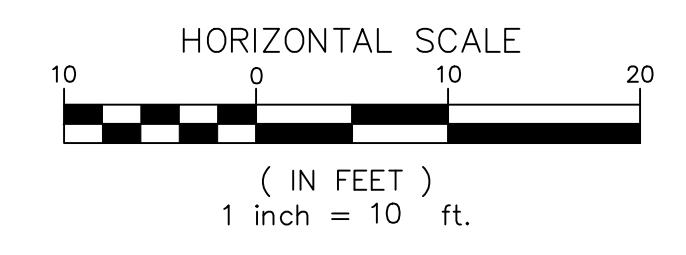
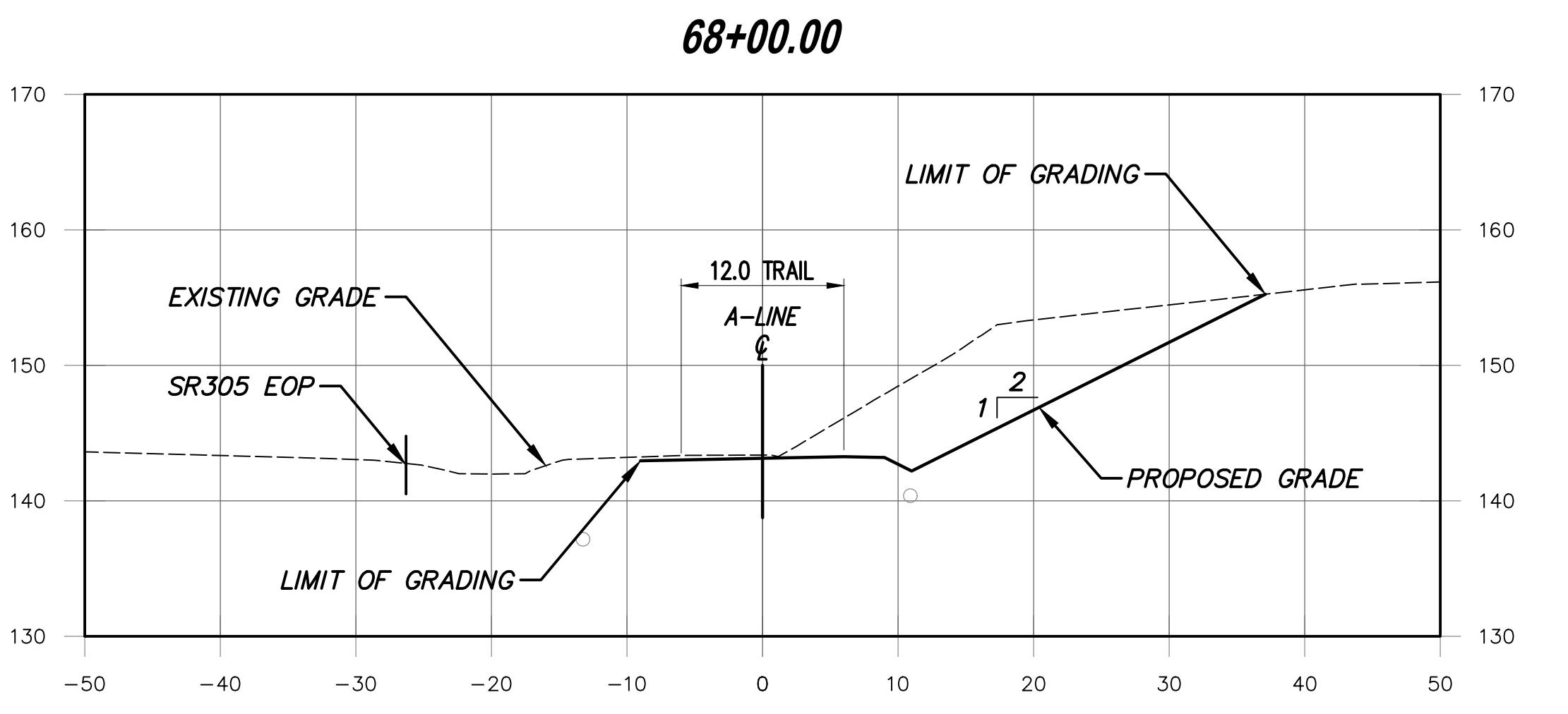
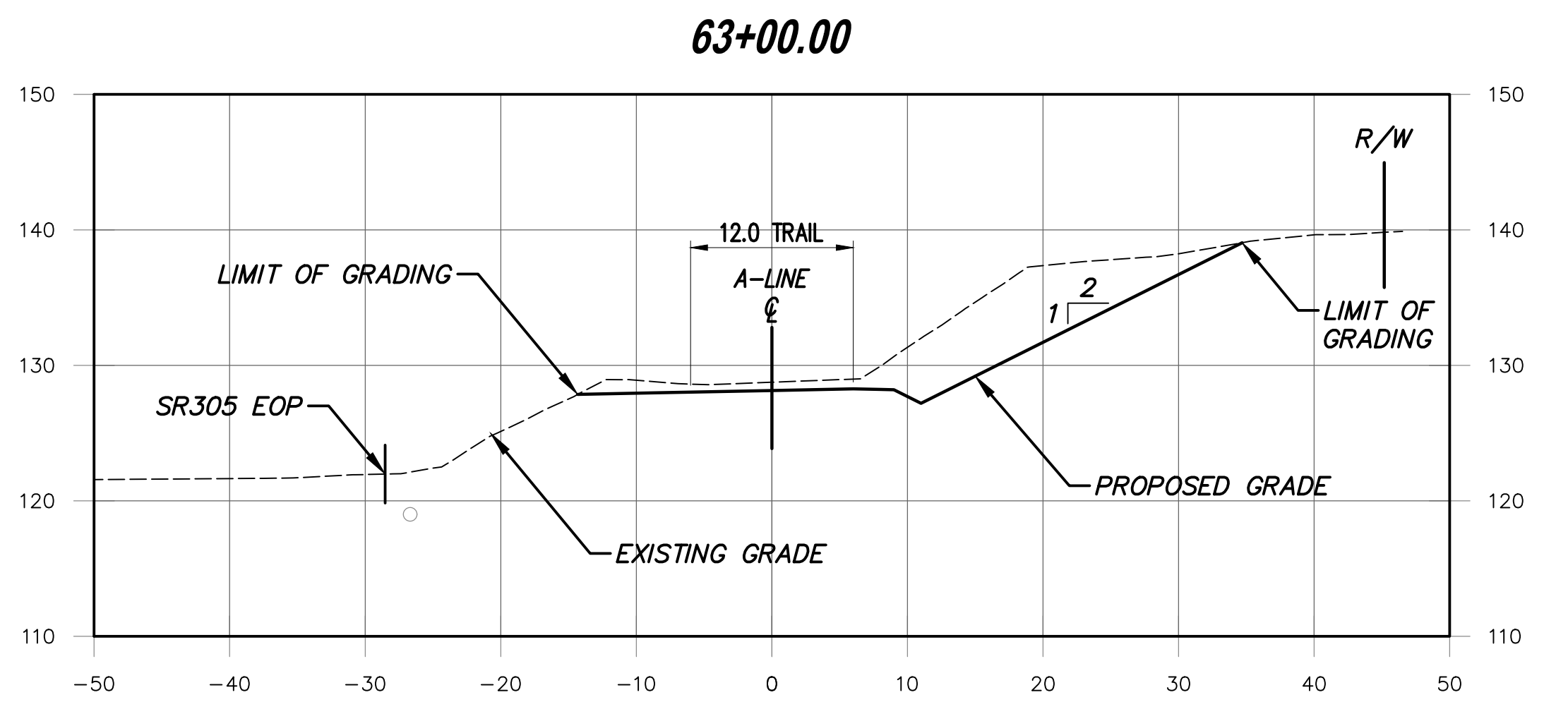
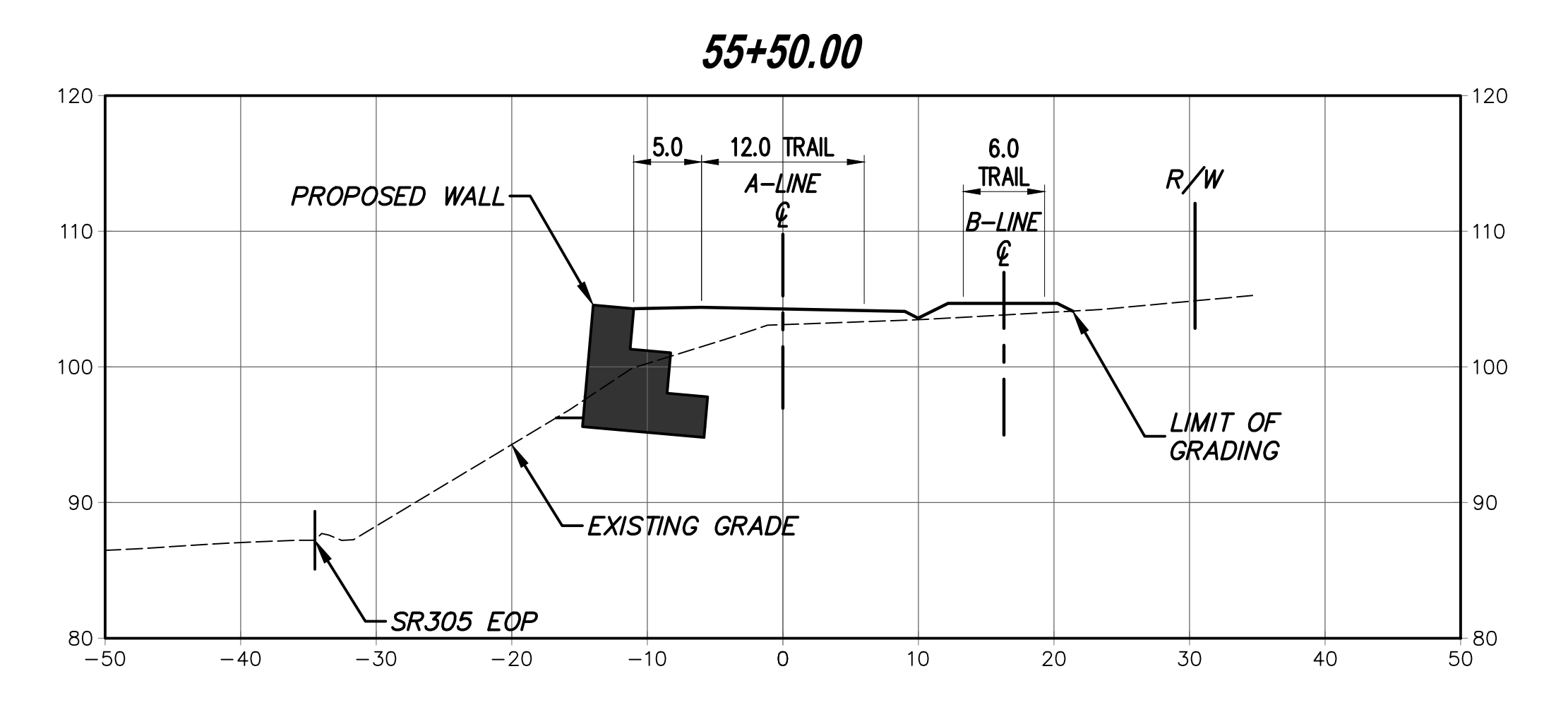
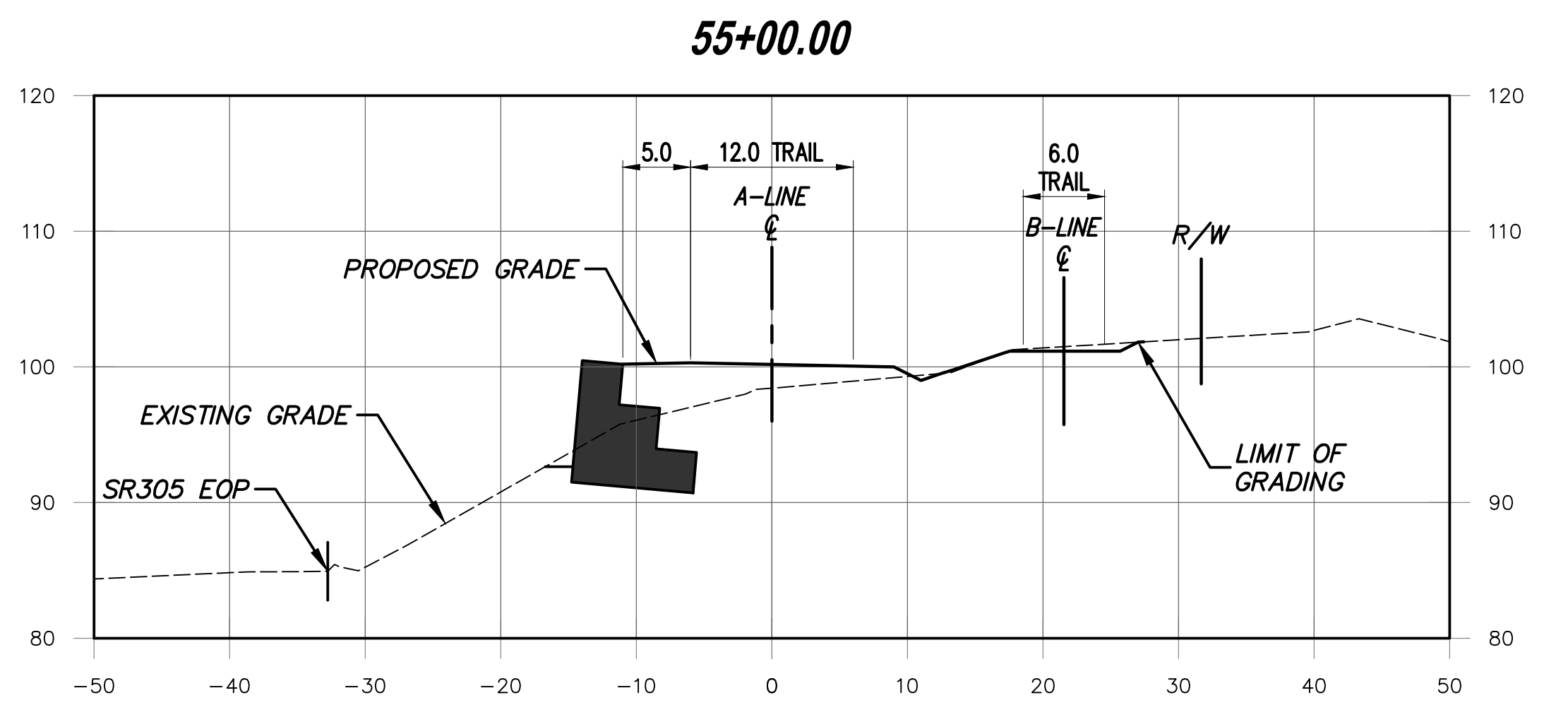
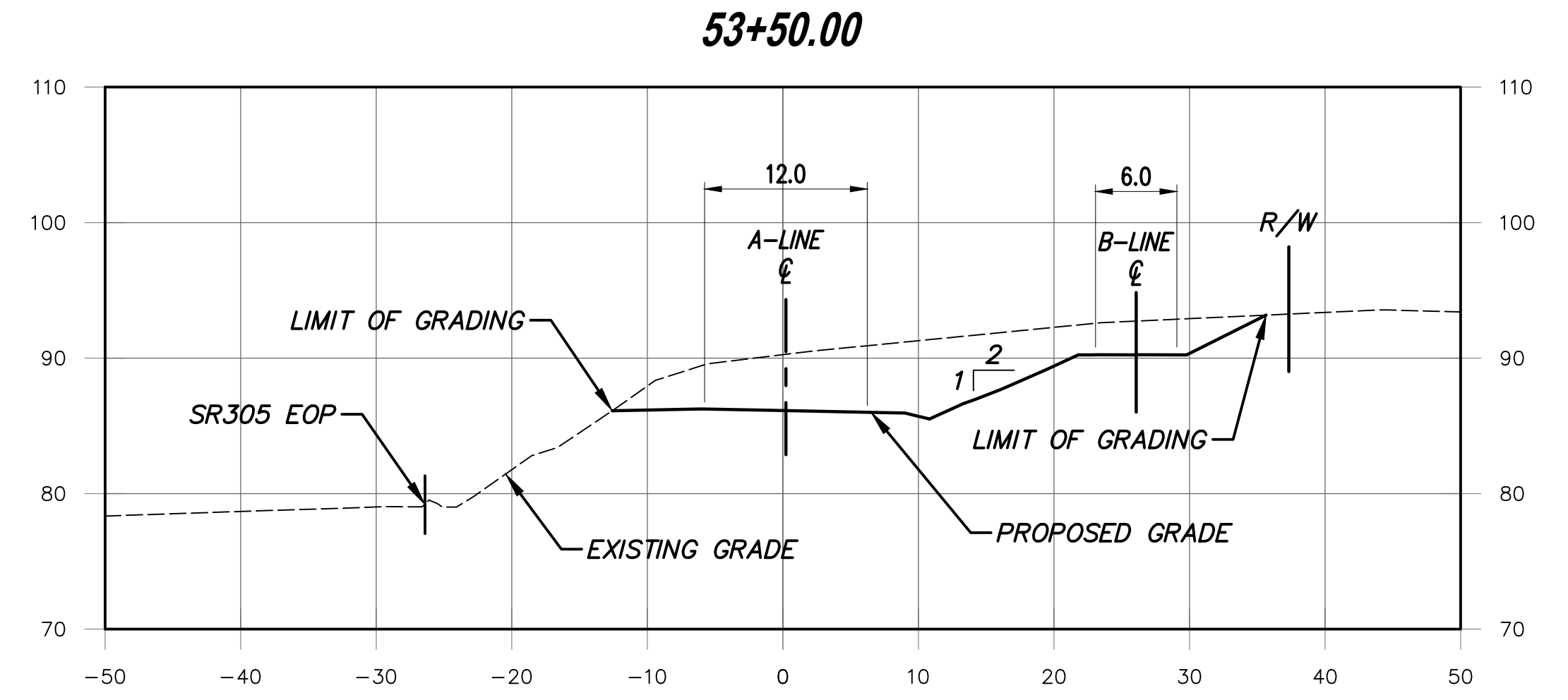
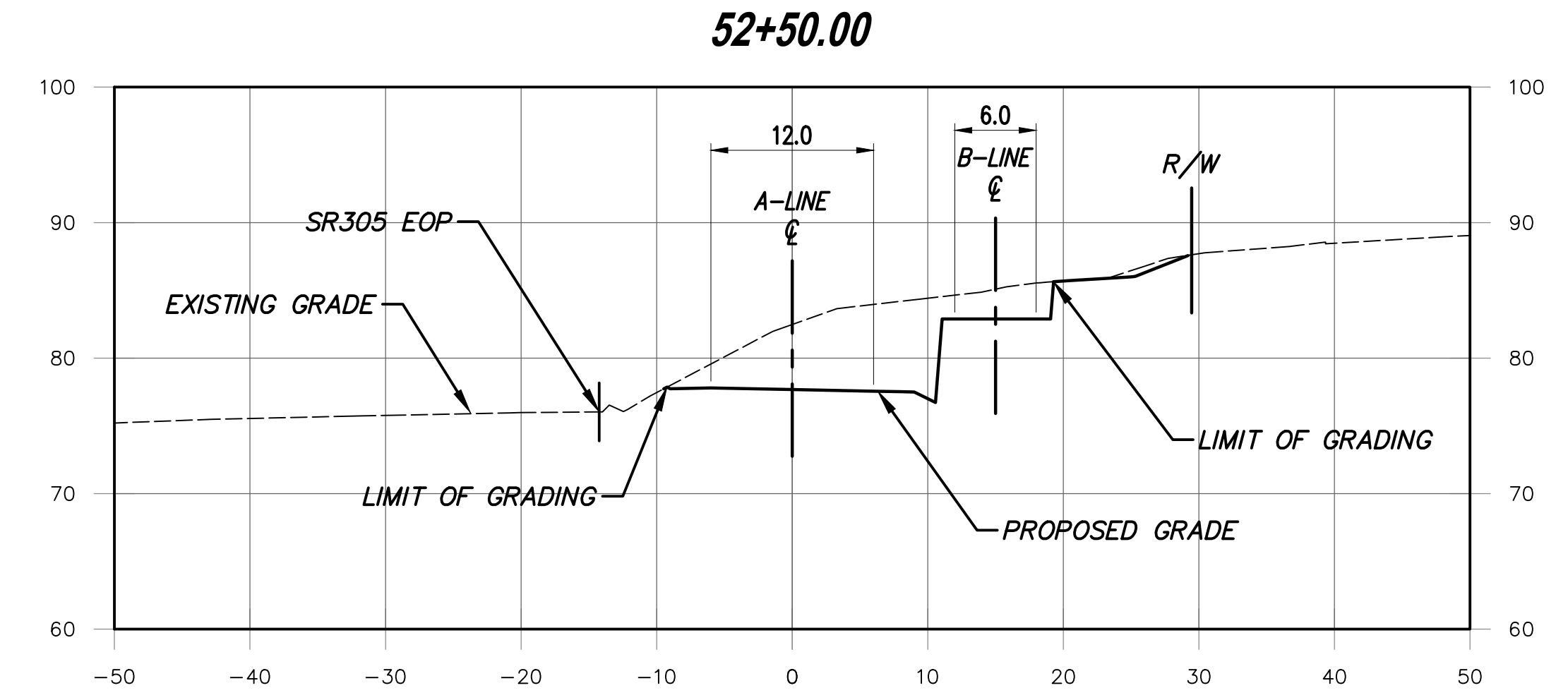

**PUBLIC WORKS
 ENGINEERING
 DEPARTMENT**

PROJECT INFORMATION

SOUND TO OLYMPIC TRAIL
 SR 305 CORRIDOR
 ENHANCEMENTS
 PHASE 2 & PHASE 4

REVISION BLOCK

NO.	DATE	BY	REVISION

Scale:
 Horiz:
 Vert:
 Coordinate System:
 Vertical Datum:
 Designed By:
 C RECKORD
 Drawn By:
 M STEWART
 Inspected By:
 W.O. No.:
 Issue Date:

CROSS SECTIONS

**MacLeod
 Reckord PLLC**
 110 Prefontaine Place South, Suite 600
 Seattle, Washington 98104
 P 206-323-7919
 F 206-323-9242

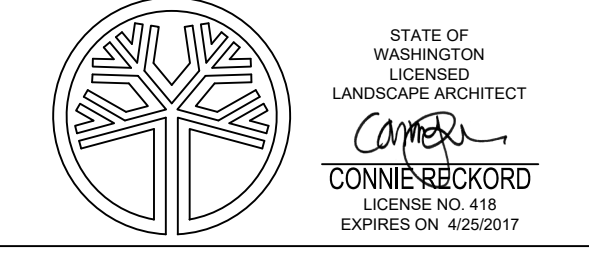

Drawing No. **C7.1**

Sheet No. **35** of **60**

Path: Z:\Projects\Sound to Olympics Trail\Bainbridge\CAD Documents\Working\STO-SECTIONS.dwg
 Plot Date: 10/19/2016 8:42 AM
 Cad User: Arielle Farina-Williams

File Name: XREF Filename:
 Drawn By: Checked By:
 Section:
 Surveyed By: Date:
 Control Monument: Field Bk/Pg:
 Recorded Survey: Kitsap County Auditor
 AF-
 Vo/Bk Page

Constructed By:
 Date:

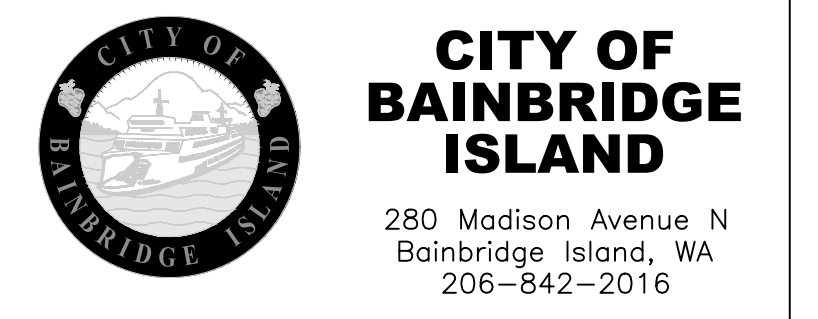
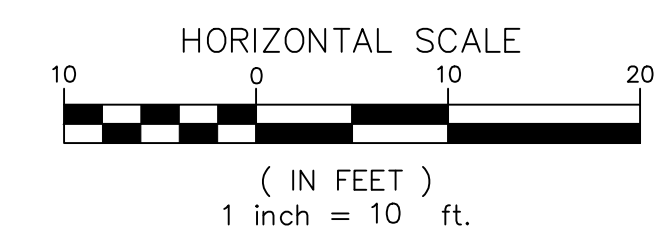
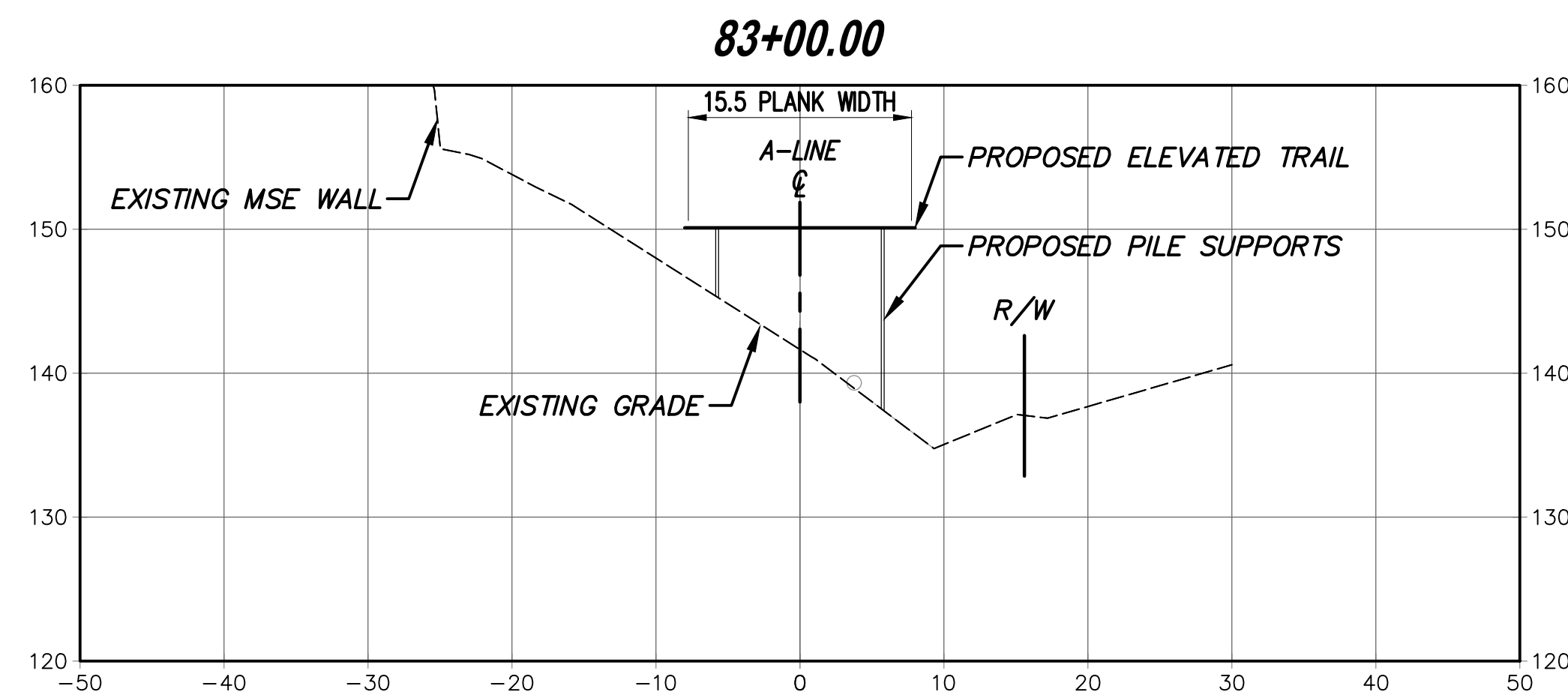
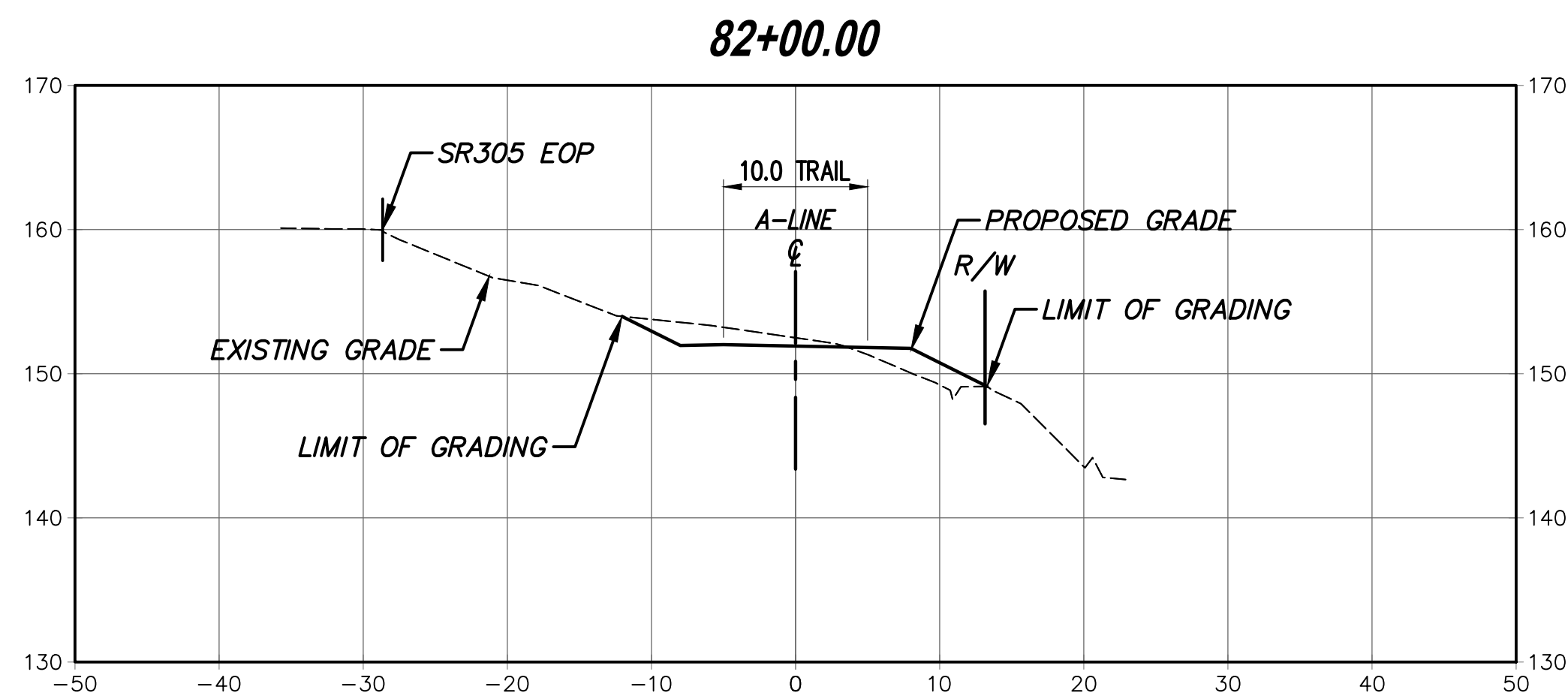
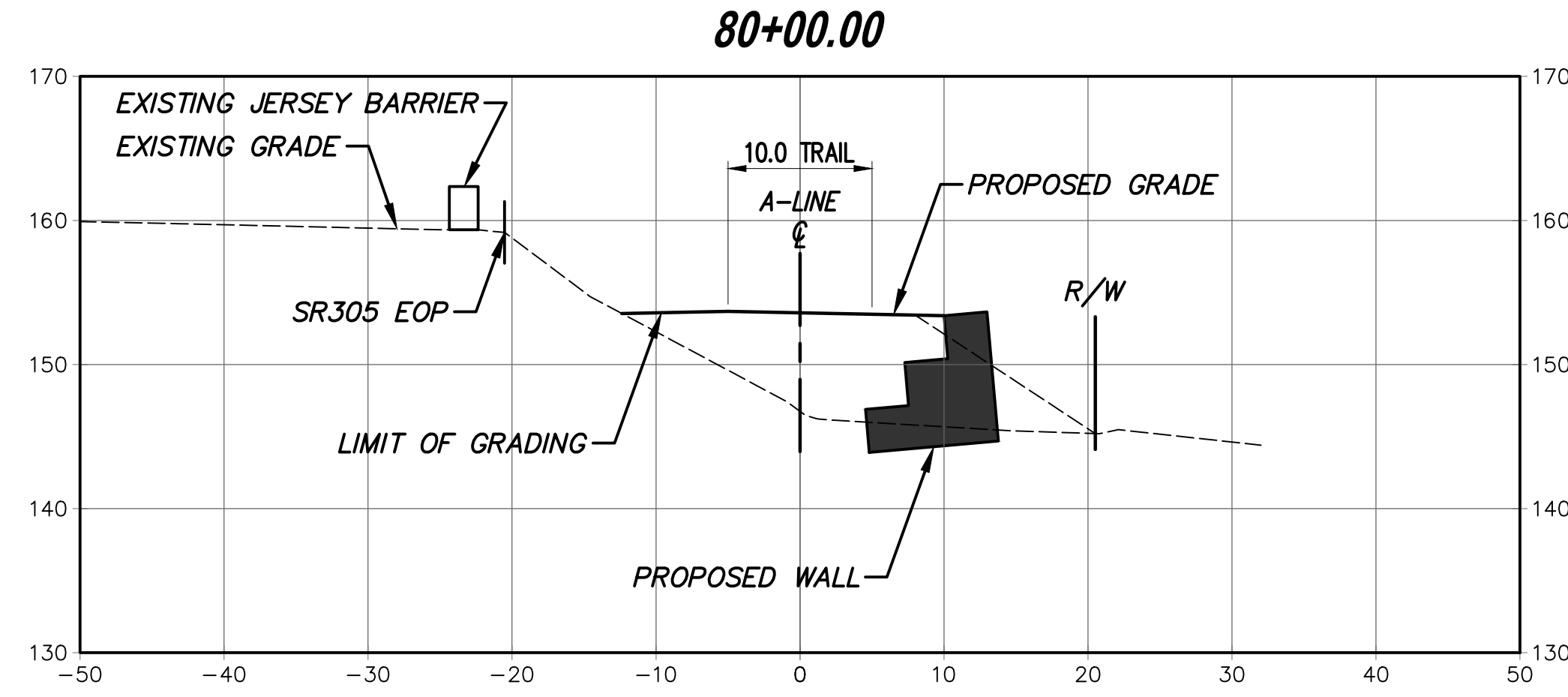
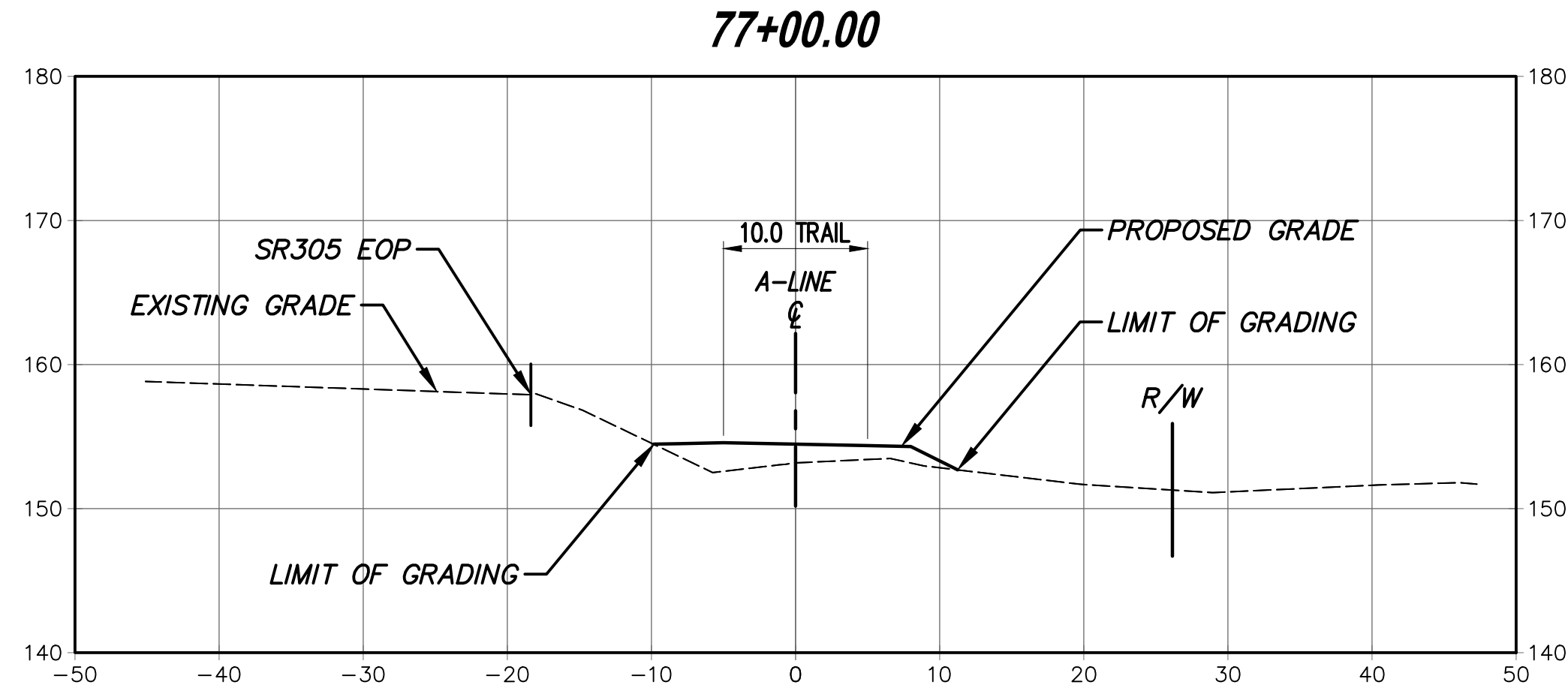
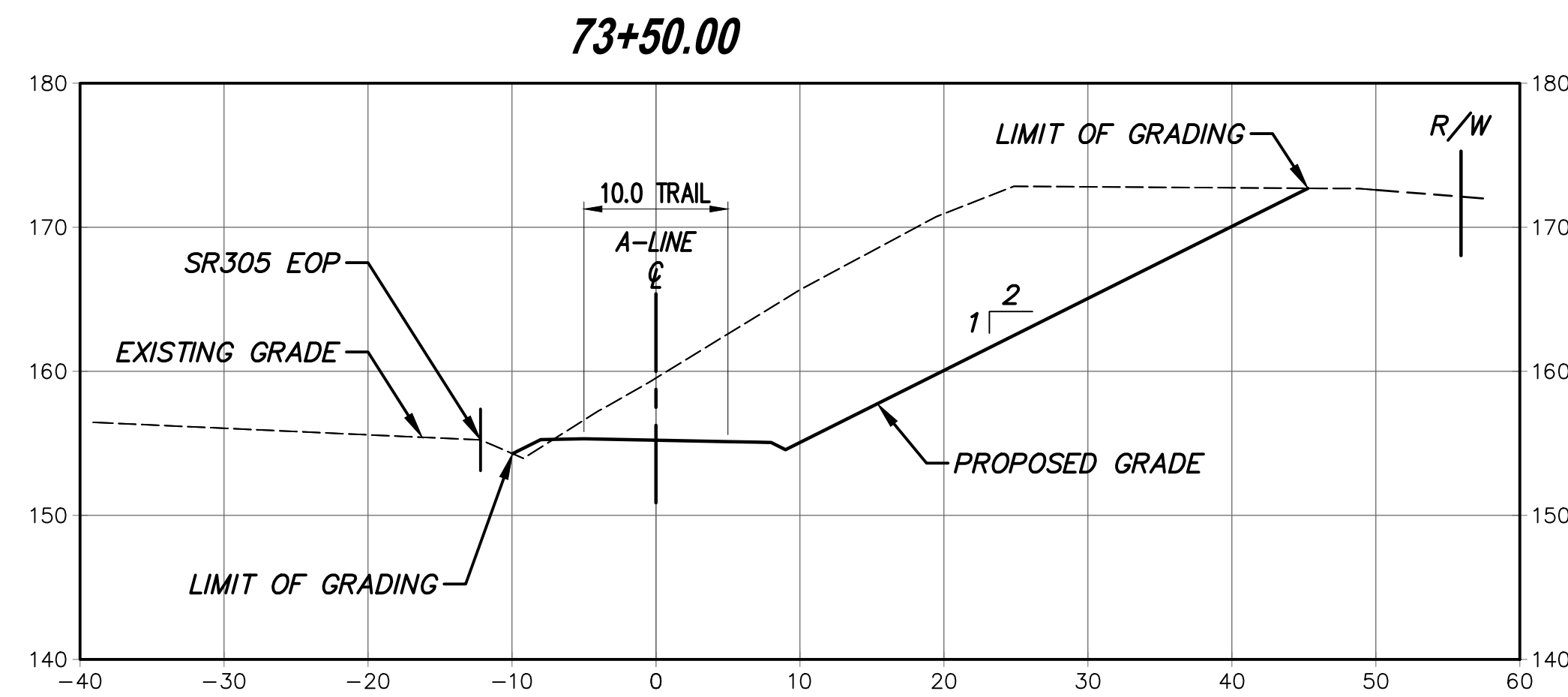
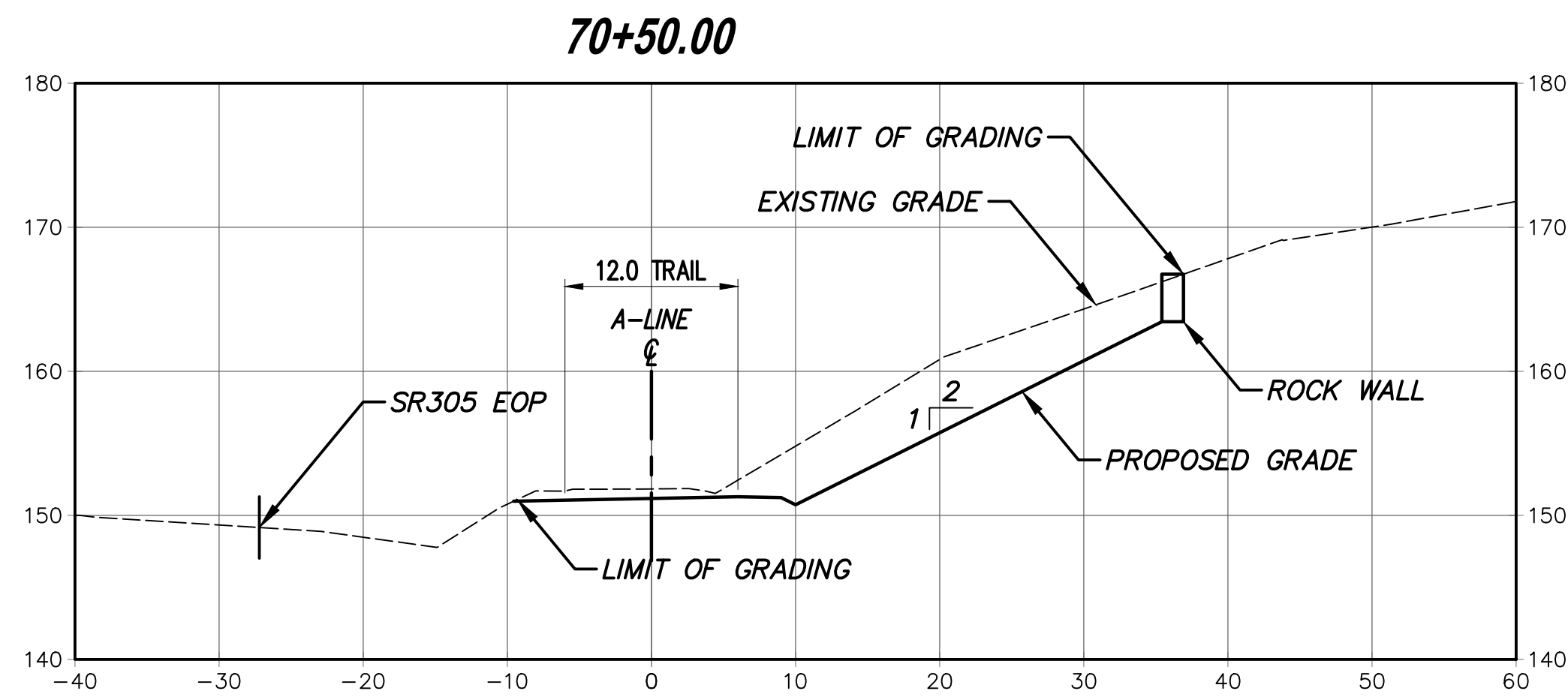

**PUBLIC WORKS
 ENGINEERING
 DEPARTMENT**

PROJECT INFORMATION

SOUND TO OLYMPIC TRAIL
 SR 305 CORRIDOR
 ENHANCEMENTS
 PHASE 2 & PHASE 4

REVISION BLOCK

NO.	DATE	BY	REVISION

SEC. 26, T. 25 N., R. 2 E., W.M.,
 CITY OF BAINBRIDGE ISLAND, KITSAP COUNTY, WA.

Scale:
 Horiz:
 Vert:
 Coordinate System:
 Vertical Datum:
 Designed By:
 C RECKORD
 Drawn By:
 M STEWART
 Inspected By:
 W.O. No.:
 Issue Date:

CROSS SECTION

**MacLeod
 Reckord PLLC**
 110 Prefontaine Place South, Suite 600
 Seattle, Washington 98104
 P 206-323-7919
 F 206-323-9242

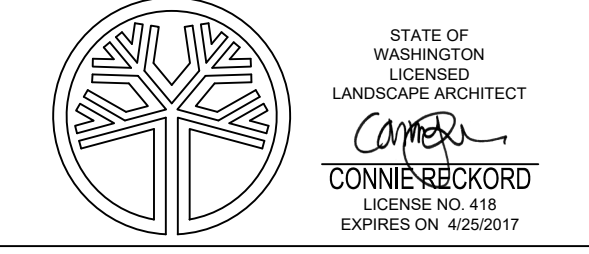

Drawing No. **C7.2**

Sheet No. **36** of **60**